



Commodity Classic Convention Center

**Sponsorship Specification
& Pricing Guide**

2017

San Antonio, TX

Artwork Deadlines & Guidelines

\$10.25/sq ft for all cling material/column wraps

\$9.75/sq ft for all banners

Artwork Deadline: COB Jan 27th (1 Month before Install)

25% surcharge if received during week of 1/30 (3 weeks before install)

40% surcharge if received during week of 2/6 (2 weeks before install)

50% surcharge if received during week of 2/13 (1 week before install)

Paramount will send all graphics to Hotels/Convention Center for final approval before printing.

Sending Files:

Please send all graphics as print ready PDF with NO BLEEDS.

Make sure all fonts are outlined and all images are linked/embedded.

If you send a file at something other than 100% please make a note of this when sending your files.

All files must be uploaded to Paramount Convention Services' FTP. You will be provided with login and password information when you are ready to upload.

Special Notes:

****Window Clings have such a variance in size and very large quantities for some of the window banks. We are requesting that you send a mock-up along with the print ready artwork. This will ensure that your graphics are laid out correctly on site.**

****Column Wraps are built using Paramount's metal system. All panels will tuck into the metal structure .25" on all edges. If you have graphics that span the vertical metal bars, please compensate for the gap of the bar (2").**

If you have any other questions or concerns regarding graphics, contact Sean Hoffert at Paramount Convention Services.

314.621.6677 or shoffert@paramountcs.com



Table of Contents

Column Wraps (Pages 6-17)

1.1 & 1.2	Main Entrance Outside Column Wrap	Page 6-7
2	Shuttle Bus Pick-Up/Drop Off Column Wraps	Page 8-9
3.1 & 3.2	Column Wrap in Main Lobby in Front of Market	Page 10-11
4	Connecting Walkway Column Wrap Down from Hall 3 Entrance	Page 8-9
5.1-5.5	Connecting Walkway Column Wrap by Hall 4	Page 14-15
6	Column Wrap at the End of Hall of Statues	Page 16-17

Window Clings (Pages 18-27)

1	Main Entrance Doors and Window Clings	Page 18-19
2	Registration Lobby Window Clings	Page 20-21
3.1 & 3.2	Hall of Statues Window Clings Overlooking Exhibit Halls	Page 22-23
4.1-4.5	Window/Door Bank at End of Hall of Statues	Page 24-25
5.1-5.8	Park View Window Clings	Page 26-27

Floor Clings (Pages 28-39)

1	Main Entrance Floor Clings	Page 28-29
2	Registration Lobby Floor Cling	Page 30-31
3.1 & 3.2	Hall of Statues Floor Clings	Page 32-33
4.1 & 4.2	Room 208-213 Hallway Floor Clings	Page 34-35
5	Connecting Walkway Floor Clings in Front of Hall 4B	Page 36-37
6	Connecting Walkway Floor Clings in Front of Seating and Concession Area	Page 38-39

Charging Station Clings (Pages 40-41)

1	Park View Charging Station Sign & Floor Clings	Page 40-41
---	--	------------

Escalator Clings (Pages 42-49)

1.1 & 1.2	Main Lobby Escalator & Wall Below Glass	Page 42-43
2	Registration Escalator Up to Hall of Statues	Page 44-45
3	Escalator Inside Hall 3 Exhibit Hall	Page 46-47
4	Escalator Inside Hall 4 Exhibit Hall	Page 48-49

Banners (Pages 50-53)

1.1-1.3	Room 208-213 Hallway Banners	Page 50-51
2.1 & 2.2	Park View Hanging Banners	Page 52-53

Outside Space (Pages 54-55)

1	Outside Space to Right of Main Entrance	Page 54-55
---	---	------------

Floor Plan Locations (Pages 56-57)

If you have any other questions or concerns regarding graphics, contact Sean Hoffert at Paramount Convention Services. 314.621.6677 or shoffert@paramountcs.com



Main Entrance Outside Column Wrap

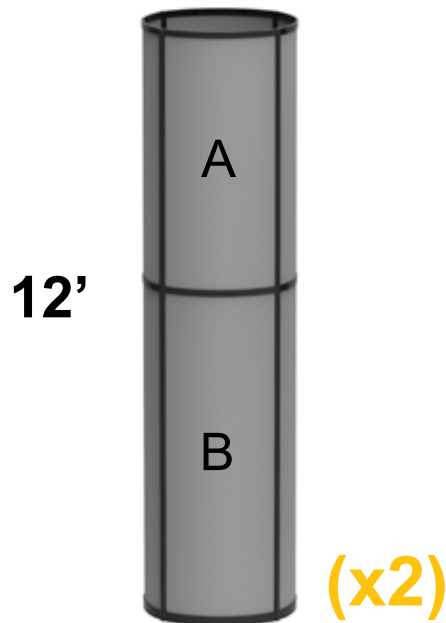

Dimensions: (W" x H")
(12')

A: 29.75" x 46.625" (x4)

B: 29.75" x 92.125" (x4)

When designing graphics that span across multiple panels, please note that the black metal bars are 2" wide.

***Needs to abide by 70/30 rule.*

Sponsorship: \$5,000/ea **Production & Installation:** \$10.25/ft²



Main Entrance Outside Column Wrap

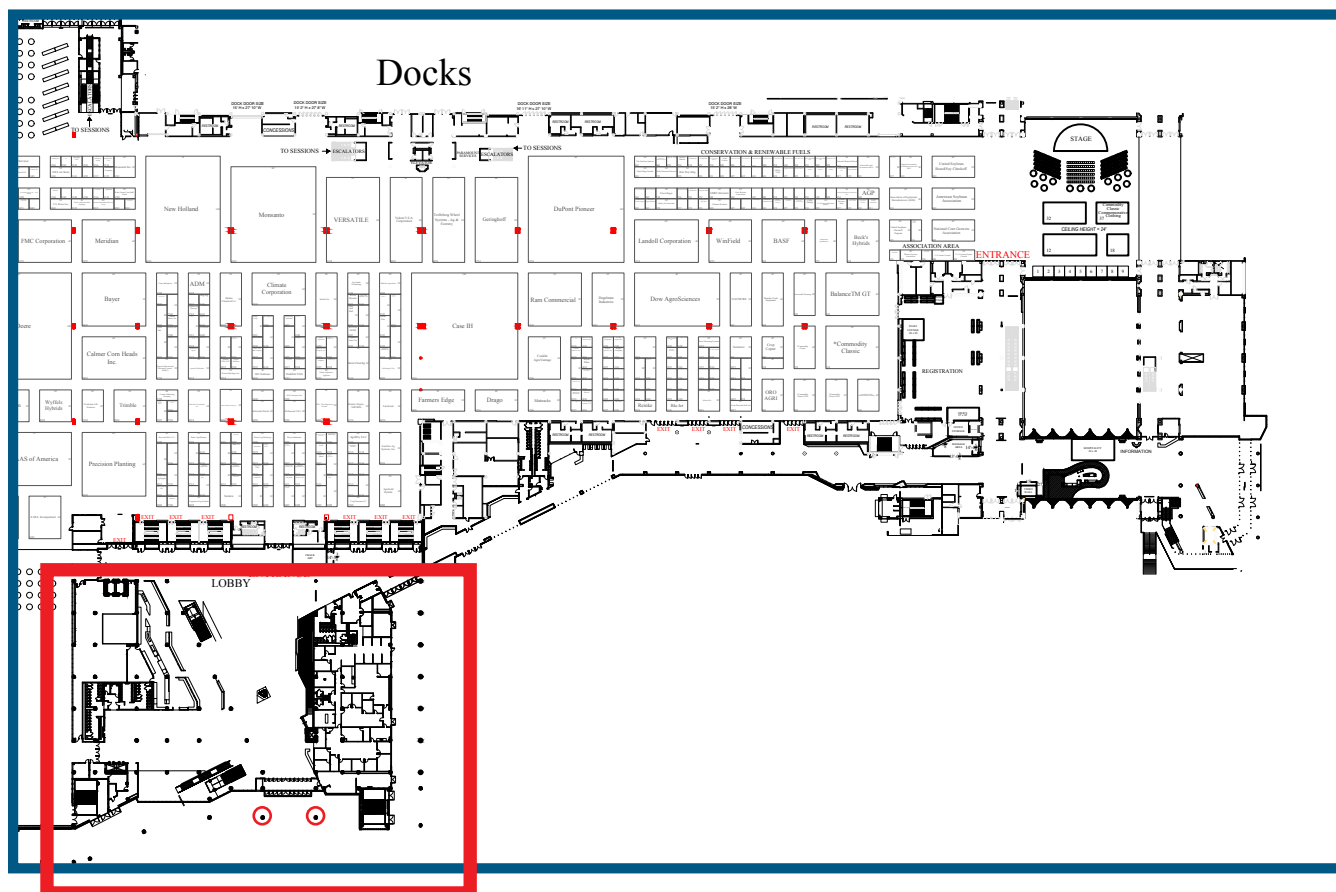
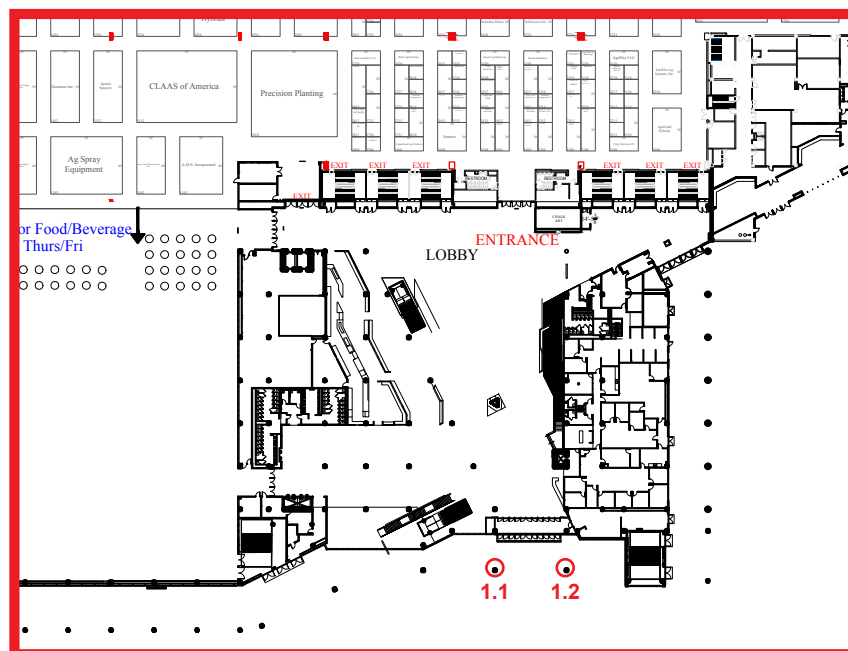

Shuttle Bus Pick-Up/Drop Off Column Wraps

12'



(x7)



Dimensions: (W" x H")
(12')

A: 29.75" x 46.625" (x4)

B: 29.75" x 92.125" (x4)

When designing graphics that span across multiple panels, please note that the black metal bars are 2" wide.

***Does not need to abide by 70/30 rule.*

Sponsorship: \$6,000/all 7 **Production & Installation:** \$10.25/ft²



Shuttle Bus Pick-Up/Drop Off Column Wraps

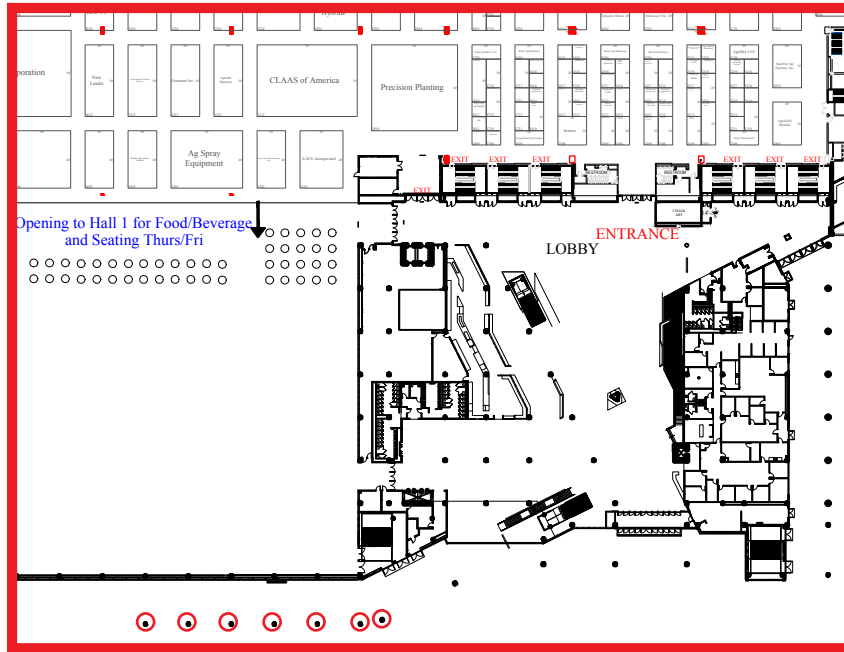

Column Wrap in Main Lobby in Front of Market

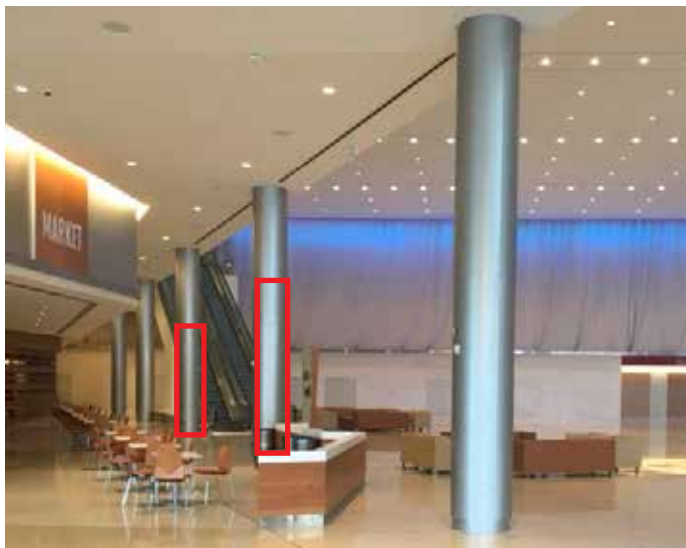
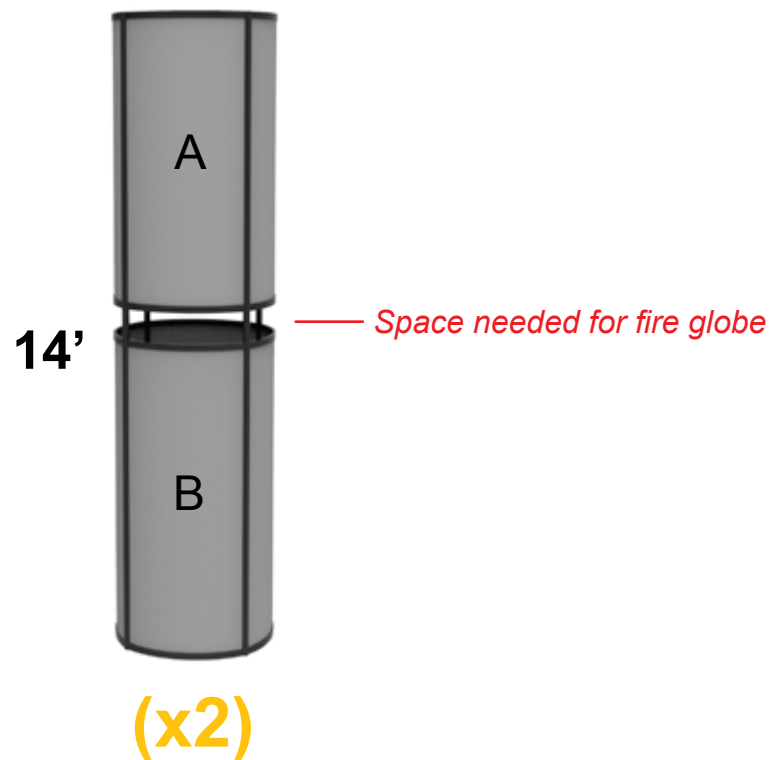

Dimensions: (W" x H")
(14')

A: 29.75" x 81" (x4)

B: 29.75" x 81" (x4)

When designing graphics that span across multiple panels, please note that the black metal bars are 2" wide.

Sponsorship: \$3,000/ea **Production & Installation:** \$10.25/ft²



Column Wrap in Main Lobby in Front of Market

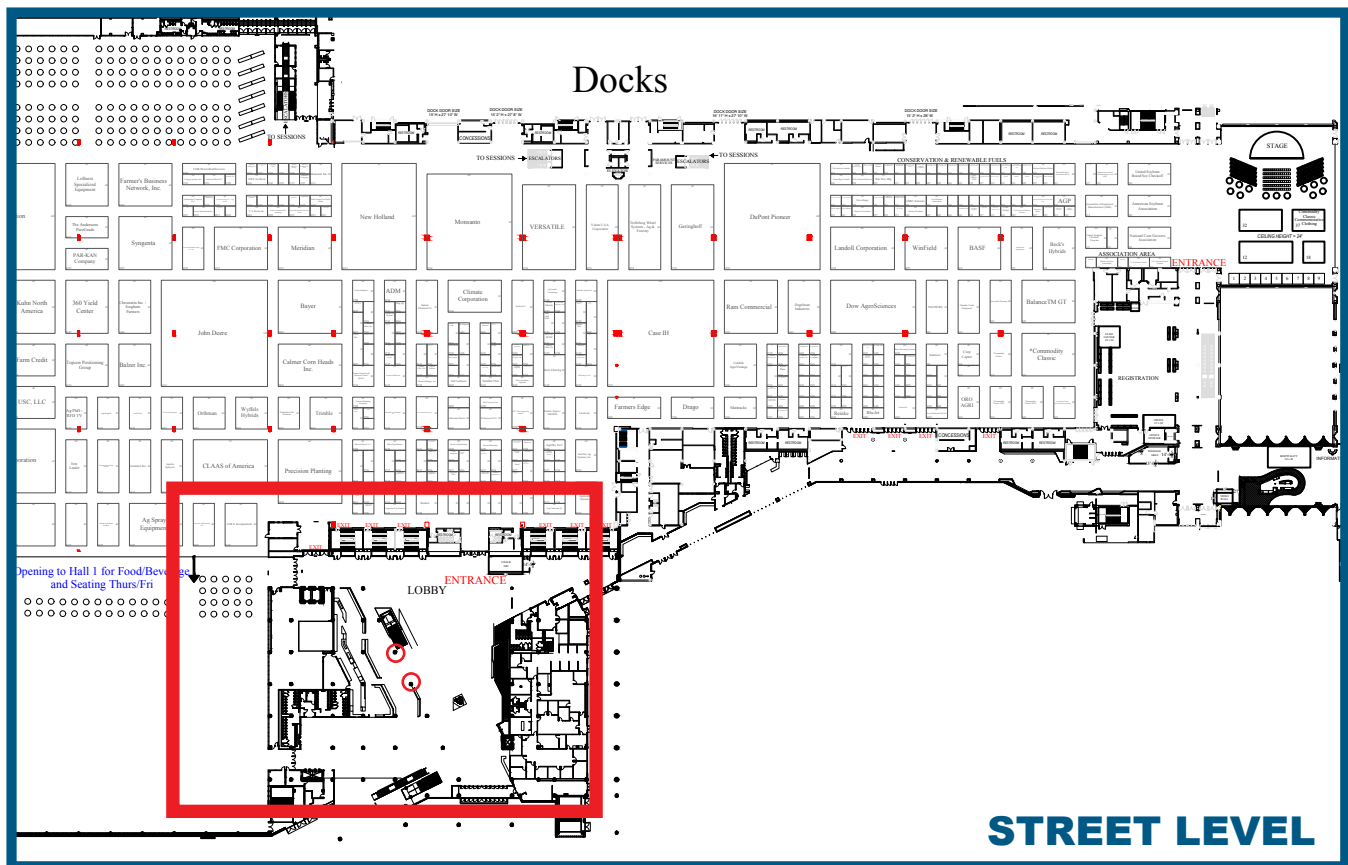
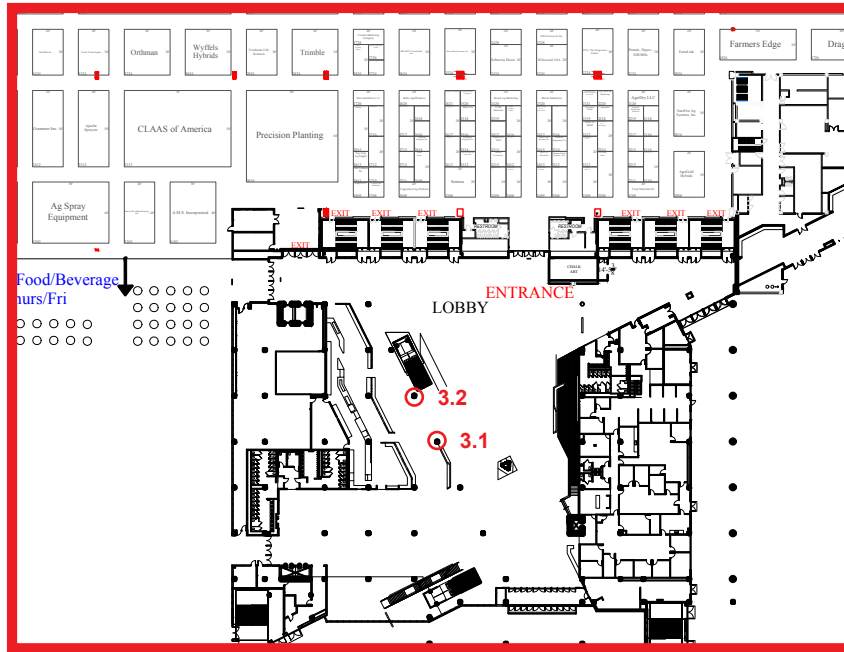

Connecting Walkway Column Wrap Down from Hall 3 Entrance

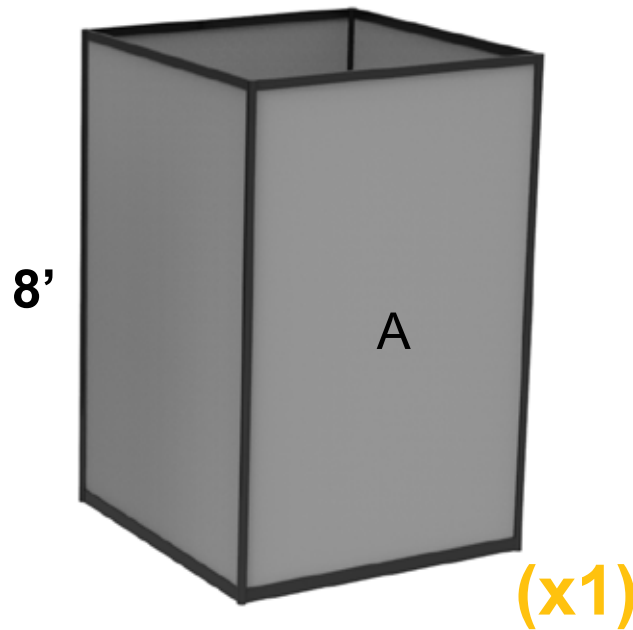

Dimensions: (W" x H")
(8')

A: 54.5" x 92.125" (x4)

Backside of column not visible from main walkway. Sponsors decision to wrap.

Sponsorship: \$3,000

Production & Installation: \$10.25/ft²



Connecting Walkway Column Wrap Down from Hall 3 Entrance

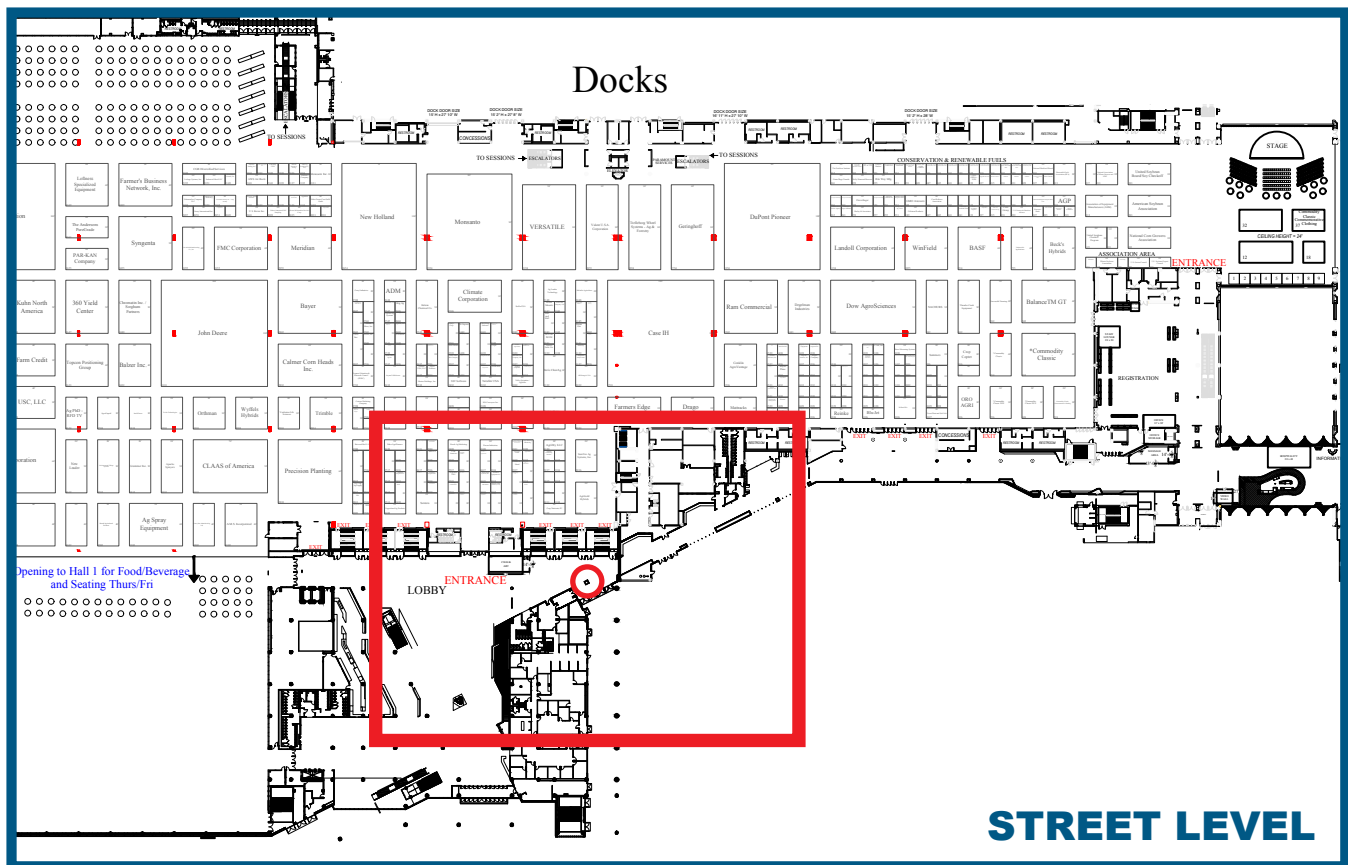

STREET LEVEL

Connecting Walkway Column Wrap by Hall 4

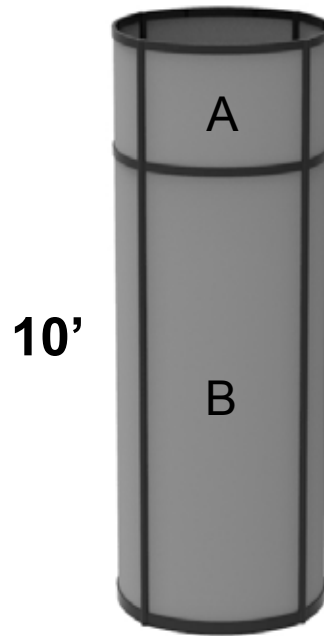

(x5)



Dimensions: (W" x H")

(10')

A: 29.75" x 22.625" (x4)

B: 29.75" x 92.125" (x4)

When designing graphics that span across multiple panels, please note that the black metal bars are 2" wide.

Sponsorship: \$3,000/ea **Production & Installation:** \$10.25/ft²



Connecting Walkway Column Wrap by Hall 4

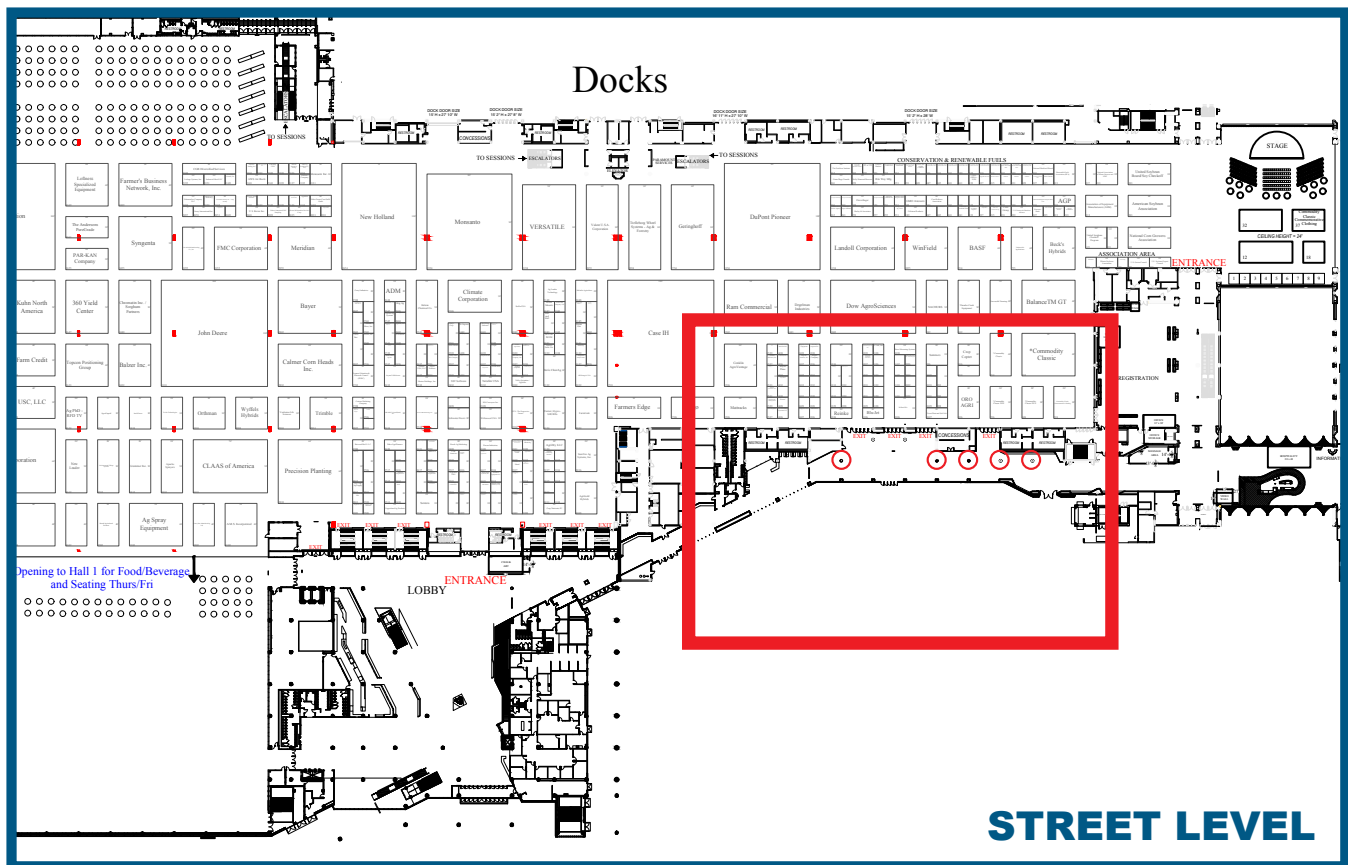
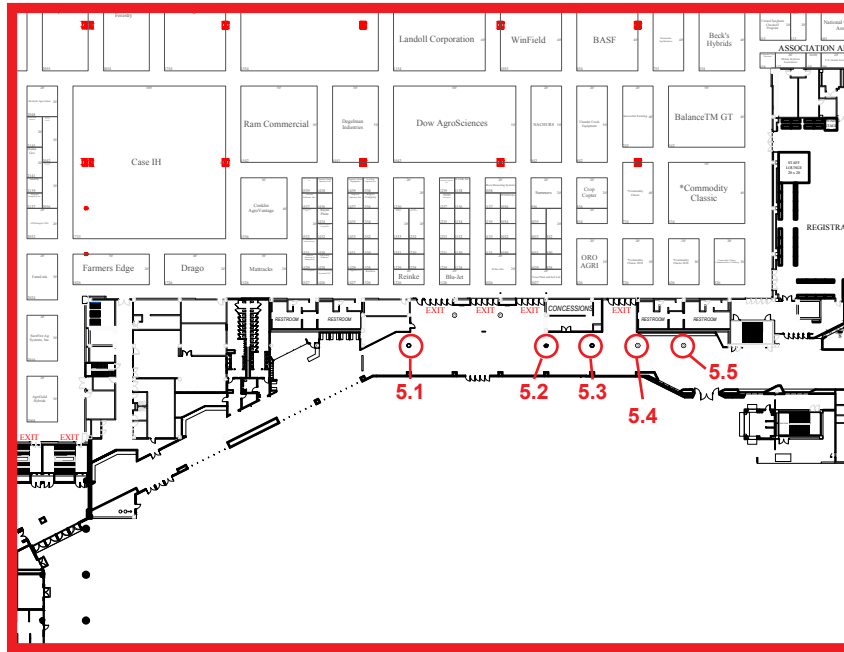

Column Wrap at the End of Hall of Statues

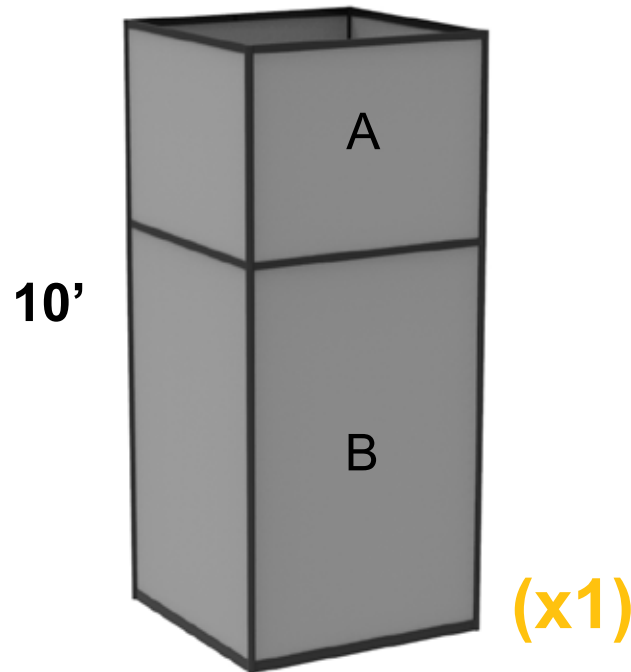

Dimensions: (W" x H")
(10')

A: 54.5" x 22.625" (x4)

B: 54.5" x 92.125" (x4)

When designing graphics that span across multiple panels, please note that the black metal bars are 2" wide.

Sponsorship: \$3,000

Production & Installation: \$10.25/ft²



Column Wrap at the End of Hall of Statues

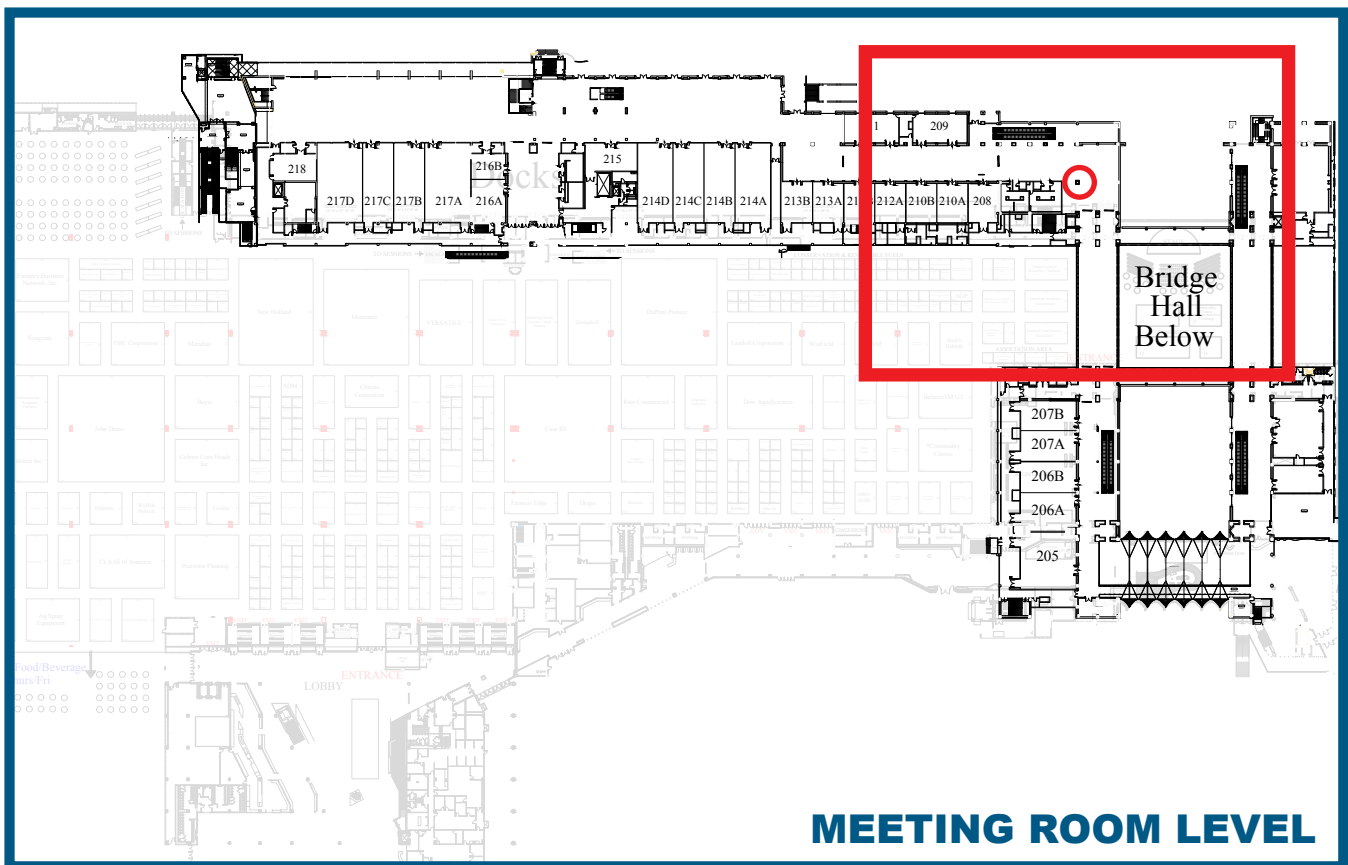
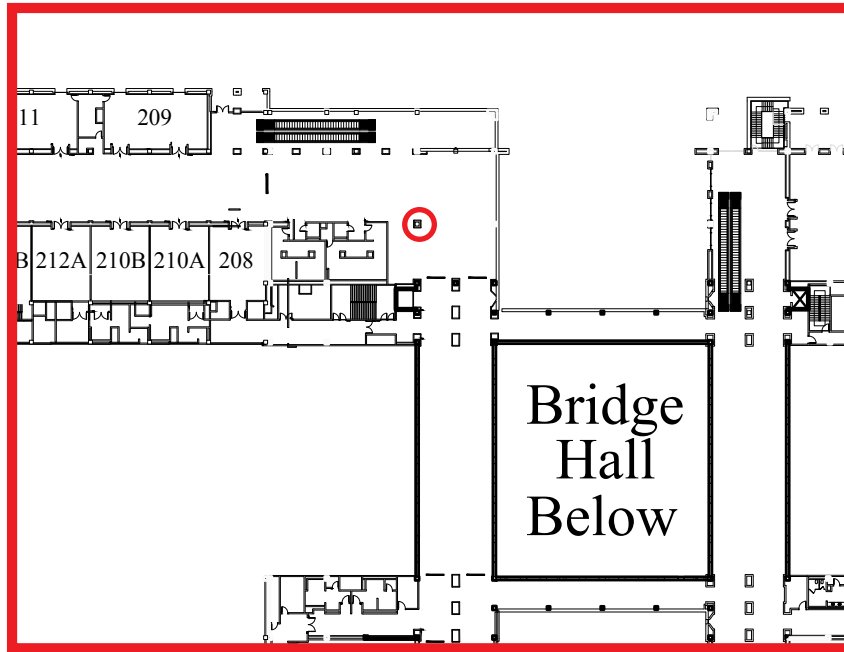

MEETING ROOM LEVEL

Main Entrance Doors and Window Clings

A ₁	A ₂	A ₃	A ₄	A ₅						
B ₁	B ₂	B ₃	B ₄	B ₅						
C ₁ *	C ₂ *	C ₃ *	C ₄ *	C ₅ *						

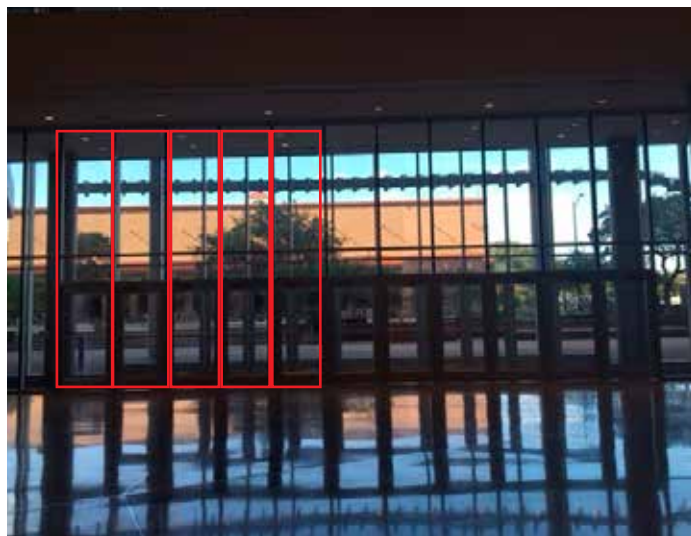
**Dimensions: (W" x H")**

A: 47" x 114" (x5 Inside/x5 Outside)

B: 45" x 22.5" (x5 Inside/x5 Outside)

C: 35.25" x 35" (x5 Inside)

C: 35.25" x 31" (x5 Outside)

There are 5 sets of windows/doors inside & 5 sets of windows/doors outside. For a total of 10 windows/doors for graphics. Metal frame around windows is 2" wide and metal frame around door windows is 6" wide.

Must abide by 70/30 rule

Sponsorship: \$5,000**Production & Installation:** \$10.25/ft²

Main Entrance Doors and Window Clings

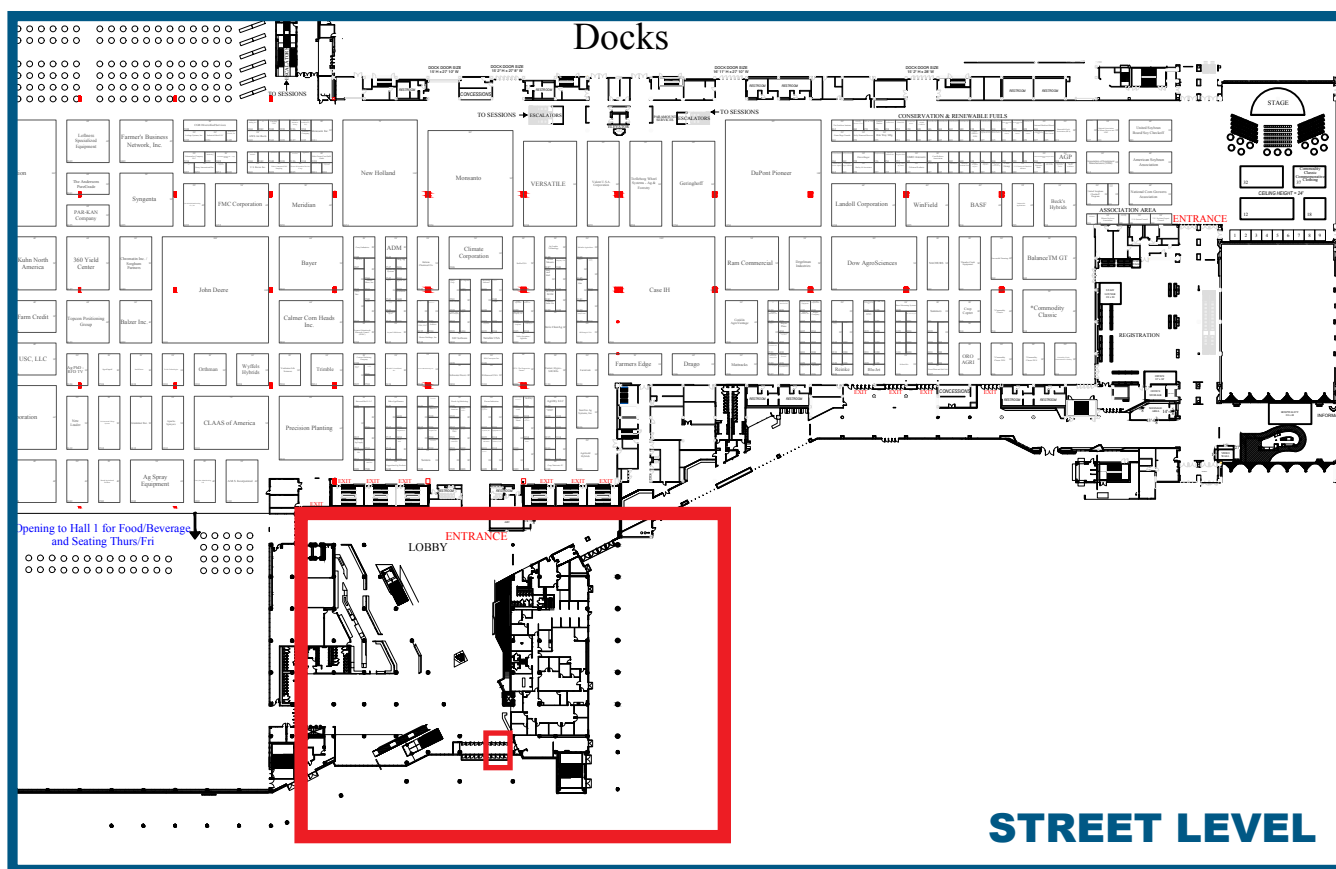
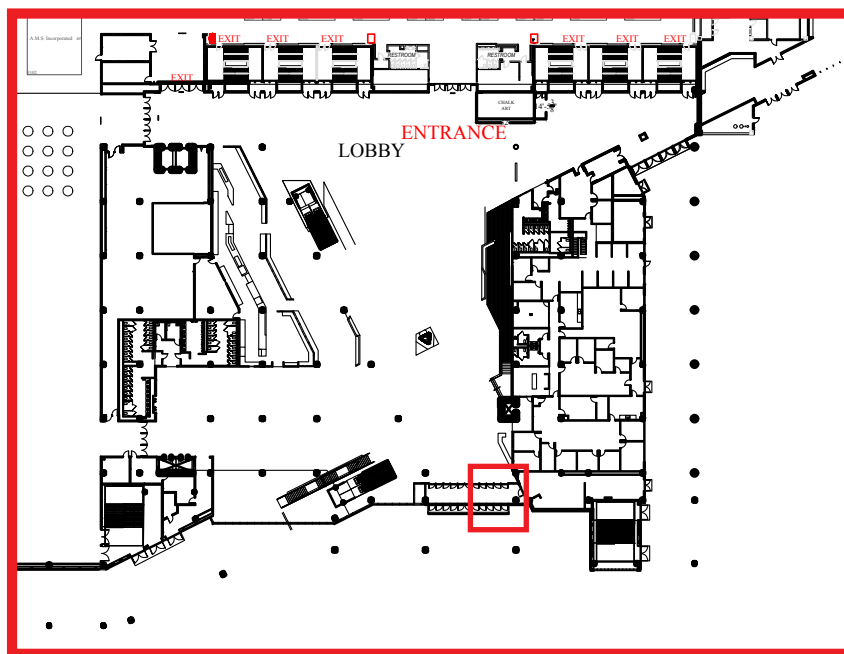

Registration Lobby Window Clings

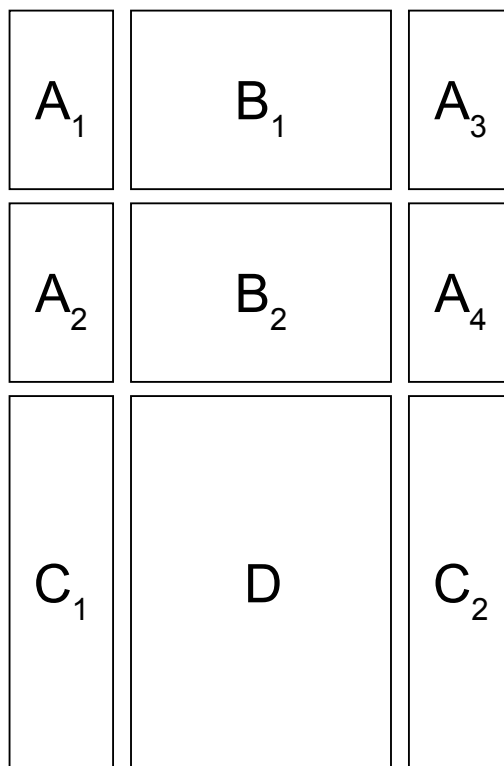

Dimensions: (W" x H")

A: 23.5" x 42.25" (x4)

B: 74" x 42.25" (x2)

C: 23" x 93" (x2)

D: 74" x 93" (x1)

*Window frame sections are 2.5" wide.
Located near escalator*

Sponsorship: \$5,000

Production & Installation: \$10.25/ft²



Registration Lobby Window Clings

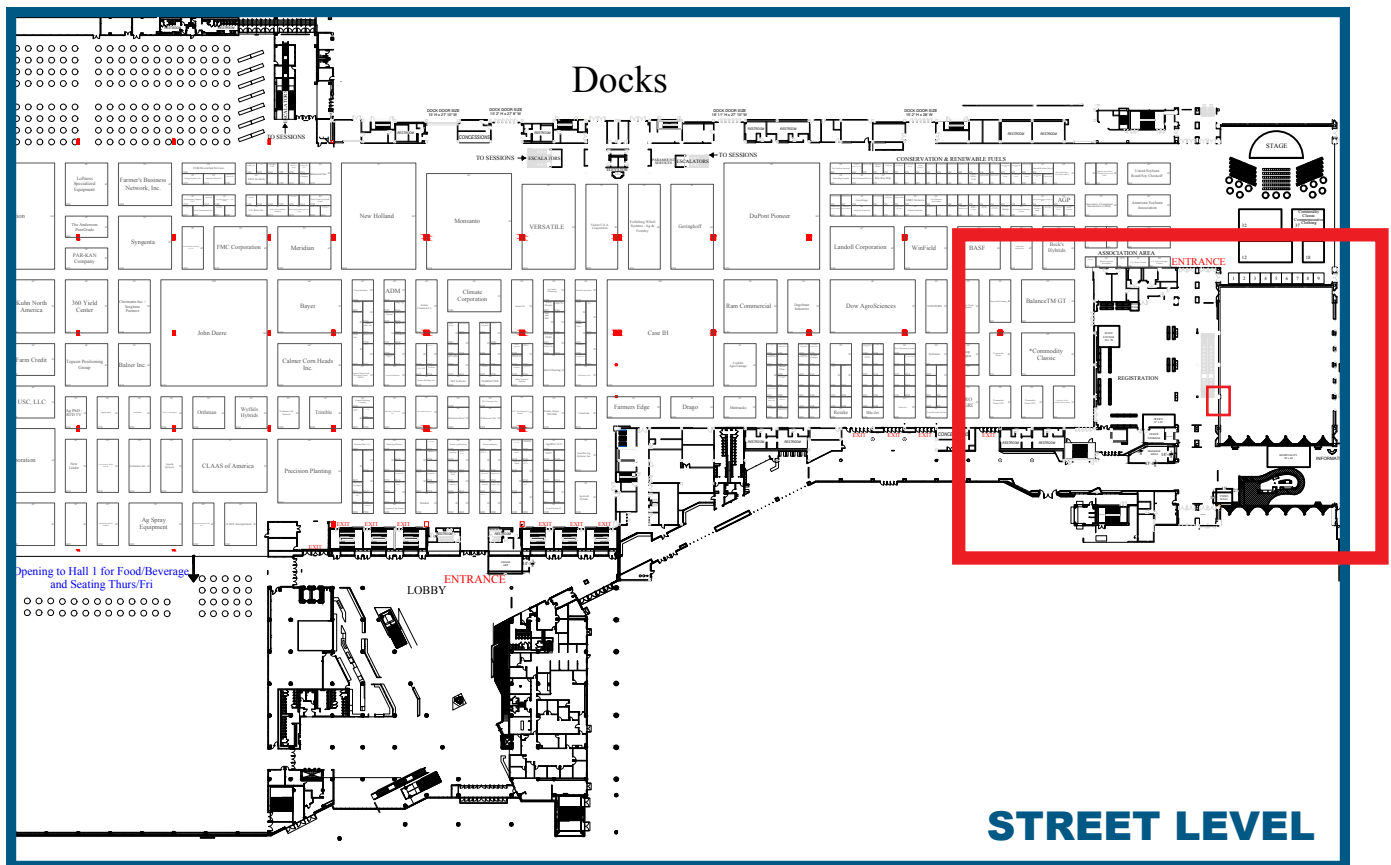
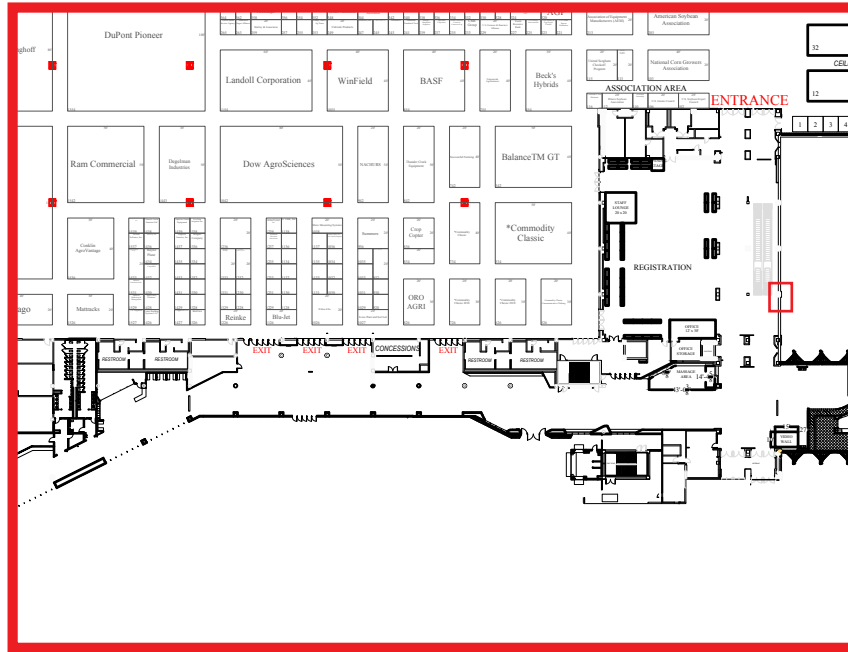

Hall of Statues Window Clings Overlooking Exhibit Halls



Dimensions: (W" x H")
37.5" x 37.5"

11 windows on each side using every other window, for a total of 6 windows on each side. Sponsor 3.1 will receive 6 windows on one side & Sponsor 3.2 will receive 6 windows on the other side.

Sponsorship: \$5,000/ea **Production & Installation:** \$10.25/ft²



Hall of Statues Window Clings Overlooking Exhibit Halls

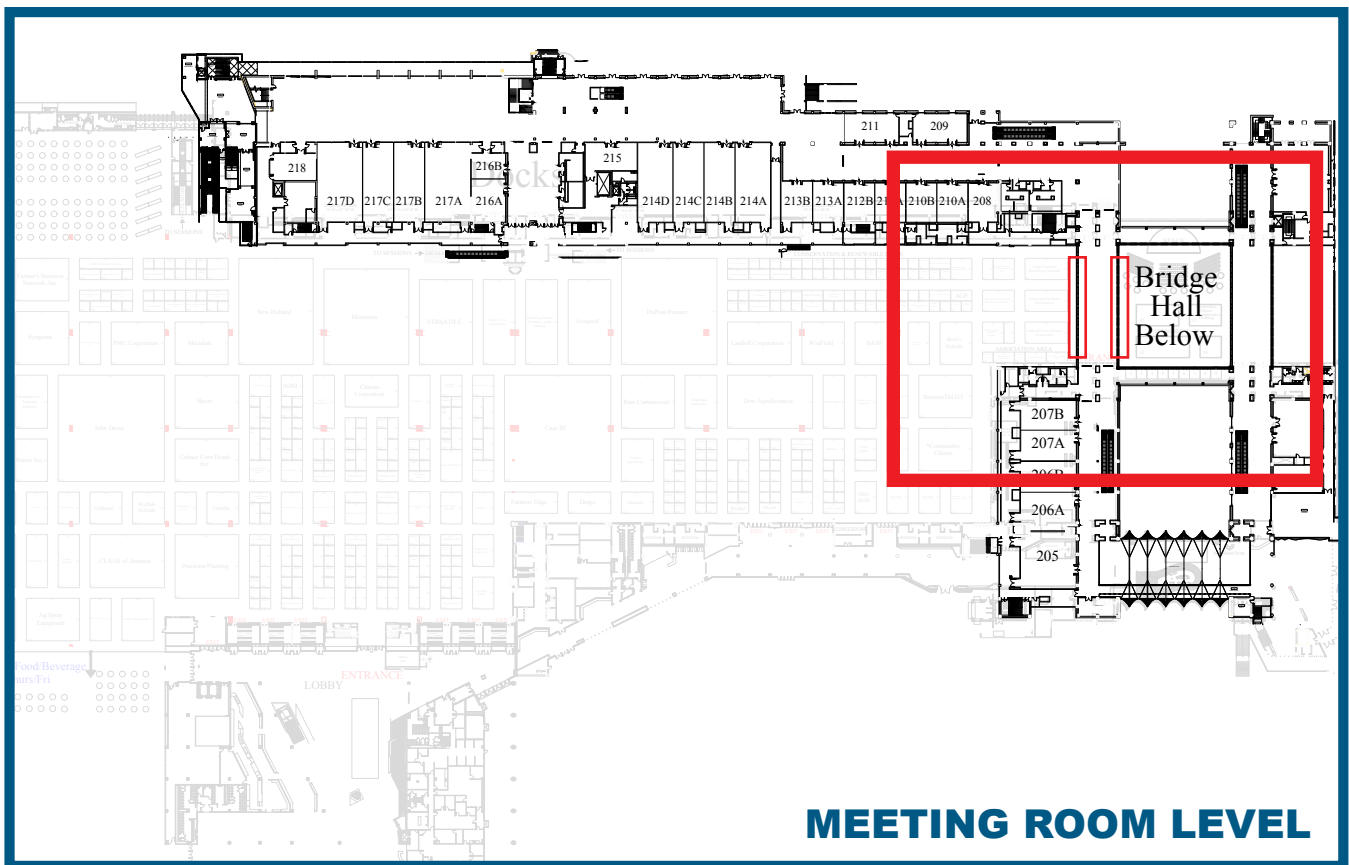
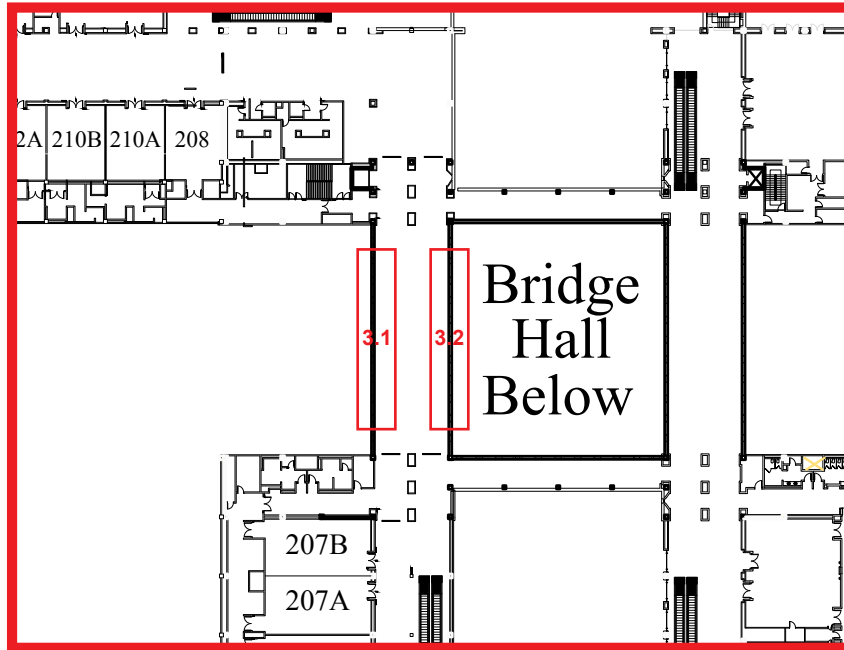

Window/Door Bank at End of Hall of Statues

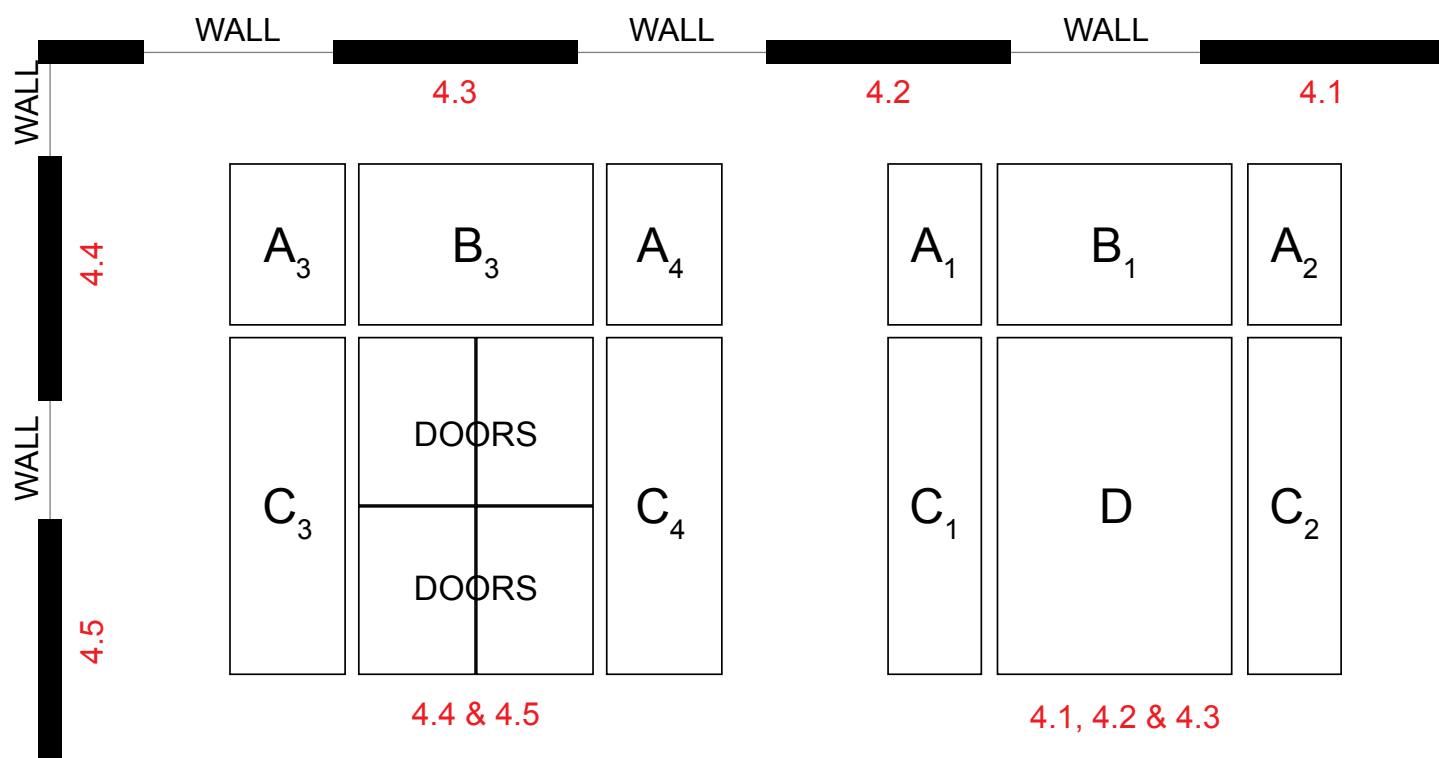

Dimensions: (W" x H")

Banks 4.1, 4.2 & 4.3

A: 23.5" x 42.25" (x2)

B: 74" x 42.25" (x1)

C: 23" x 93" (x2)

D: 74" x 93" (x1)

Banks 4.4 & 4.5

A: 32.5" x 42.25" (x2)

B: 73.75" x 42.25" (x1)

C: 32.25" x 93" (x2)

*Window frame sections are 2.5" wide.
All graphics will face inside.*

Sponsorship: \$5,000/ea

Production & Installation: \$10.25/ft²



Window/Door Bank at End of Hall of Statues

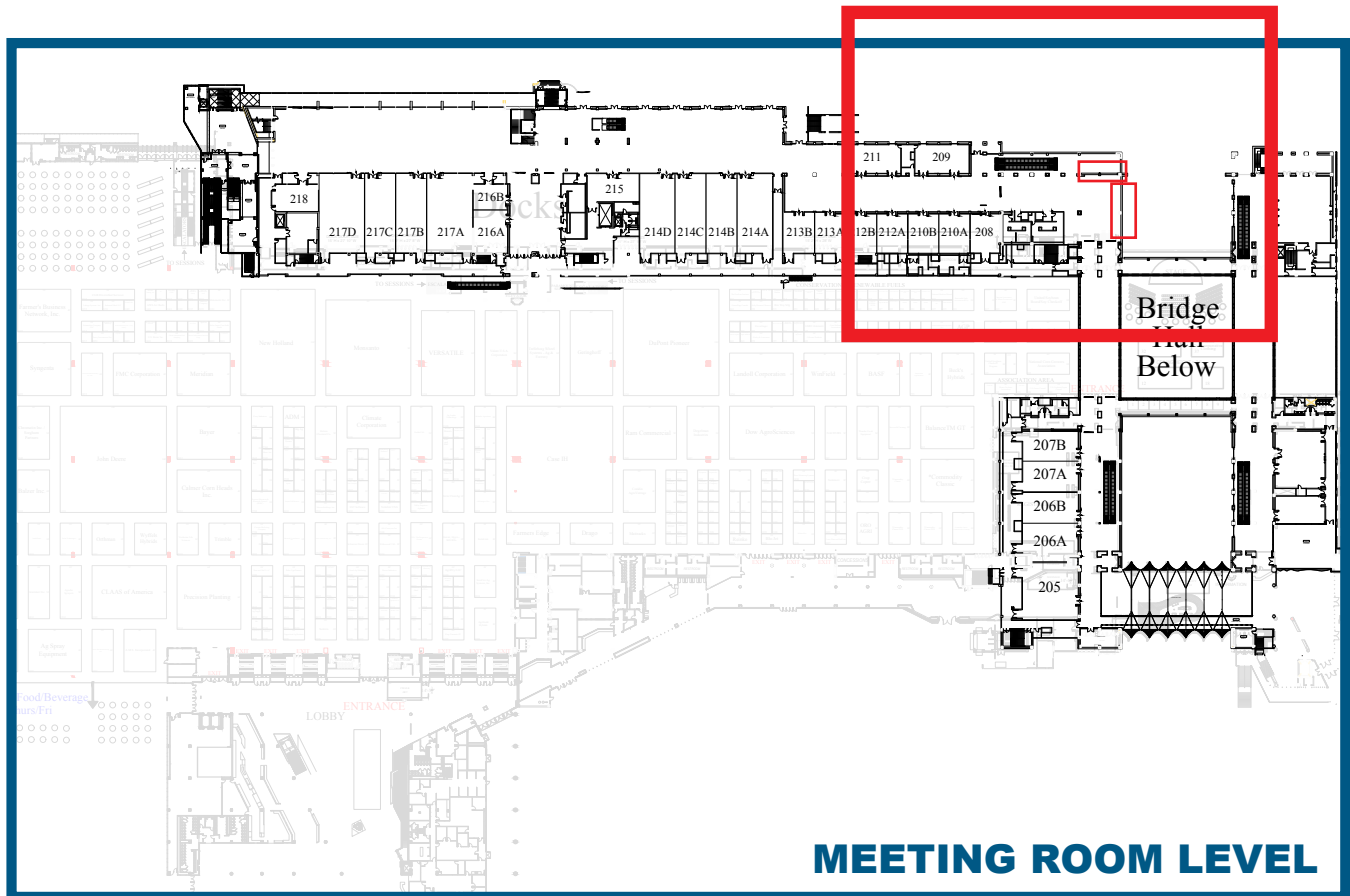
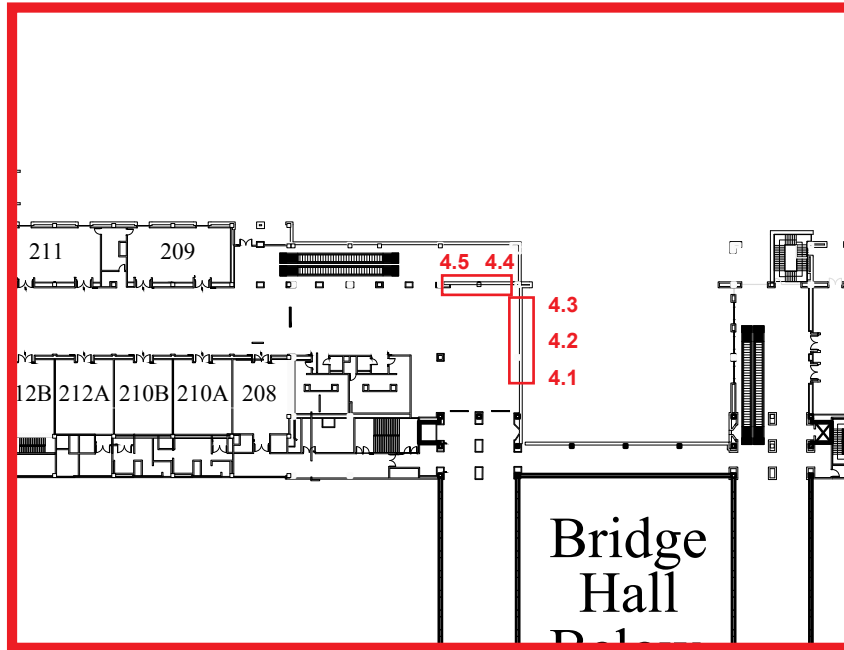

MEETING ROOM LEVEL

Park View Window Clings

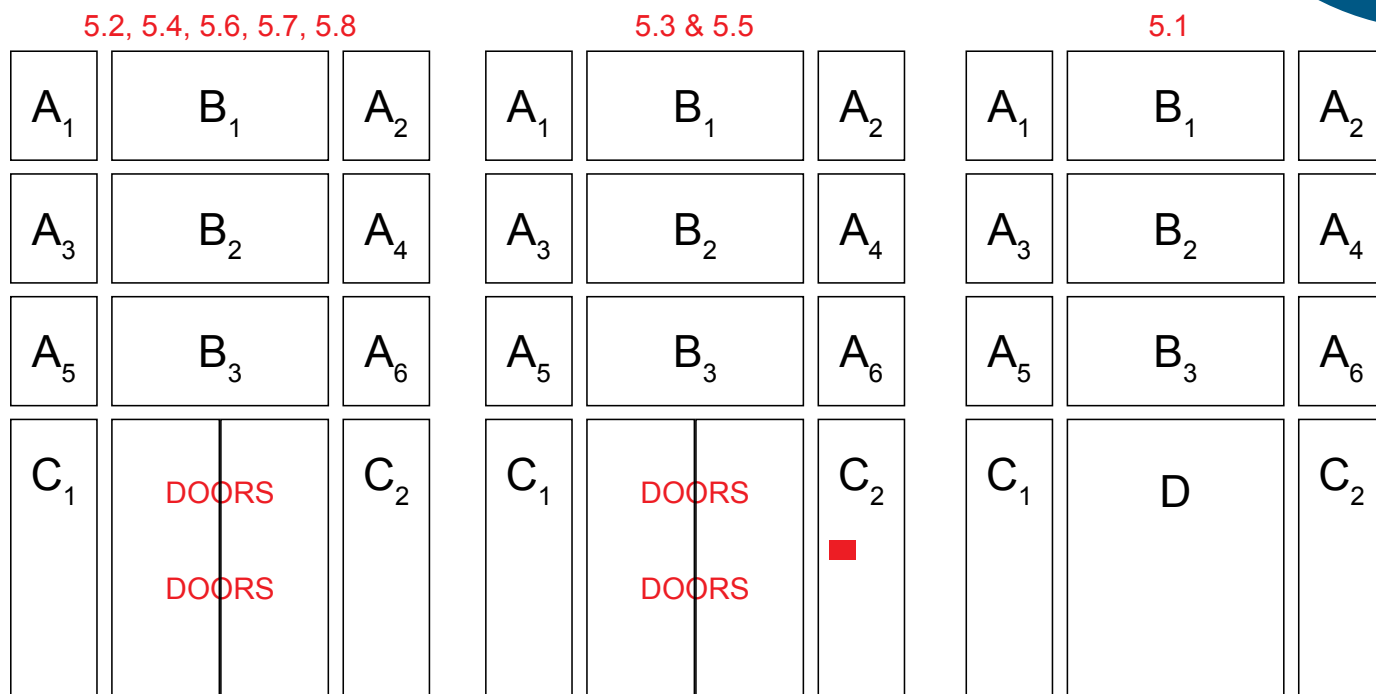

(x8 Total Banks)(7 Doors/1 Window)



Dimensions: (W" x H")

All Window Banks

A: 35.75" x 44.75" (x6)

B: 85.5" x 44.75" (x3)

C: 35.75" x 93" (x2)

*D: 85.5" x 93" (x1) Only for #1

#1 Window Only

#3 & #5 Small exit sign on lower right window. No graphics on door

#2,4,6,7,8 Windows no graphics on door

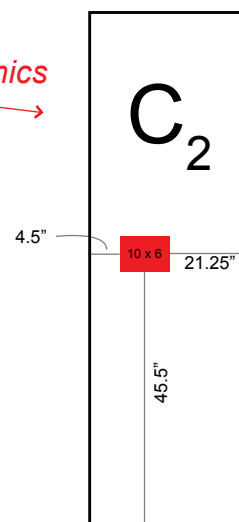

Sponsorship: \$5,000/ea

Production & Installation: \$10.25/ft²



Park View Window Clings

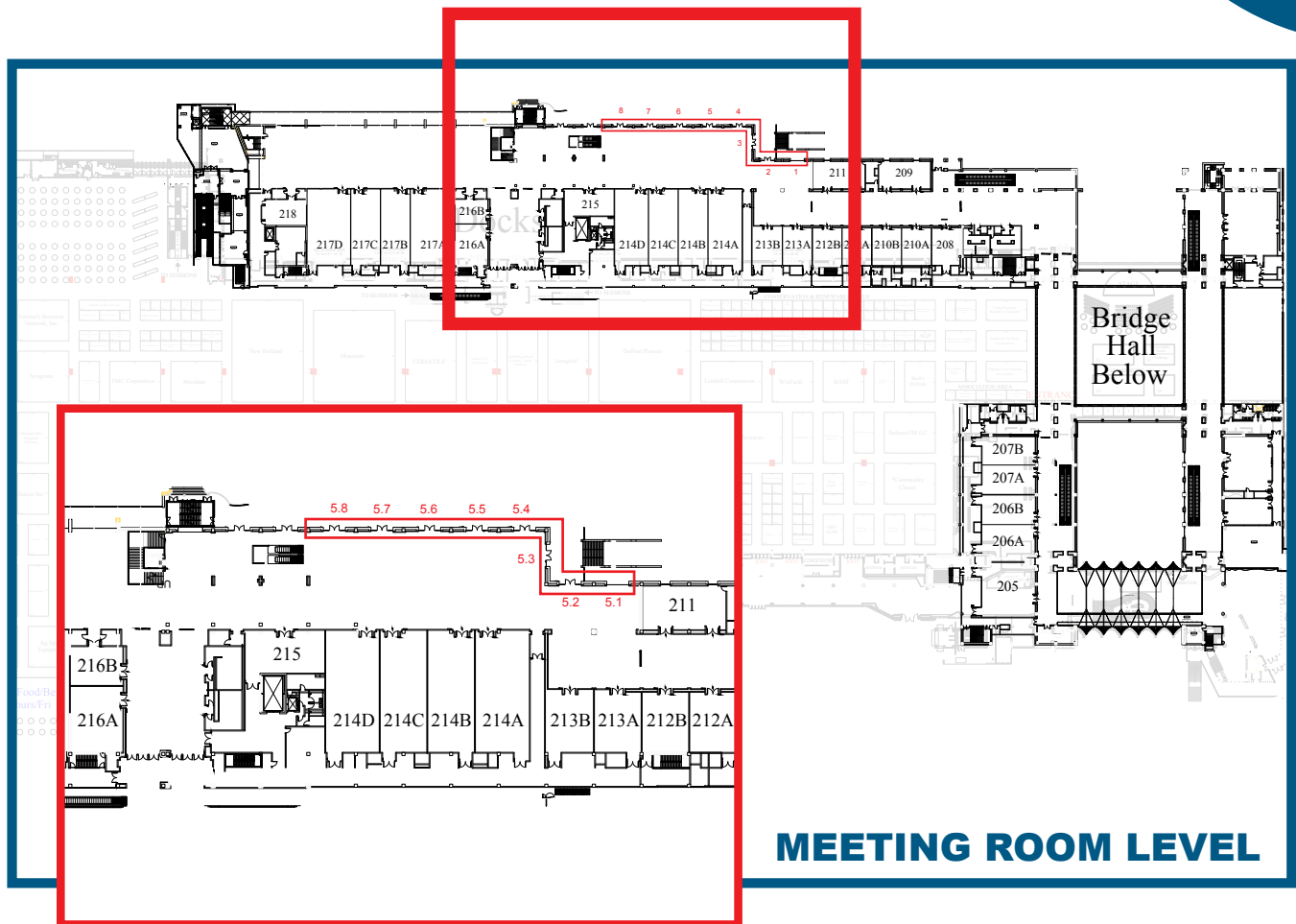

Window frame
sections are
2.5" wide

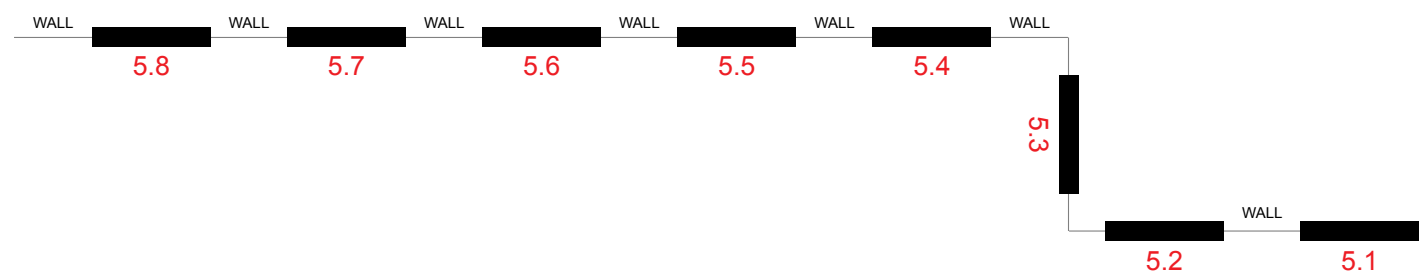

Main Entrance Floor Clings

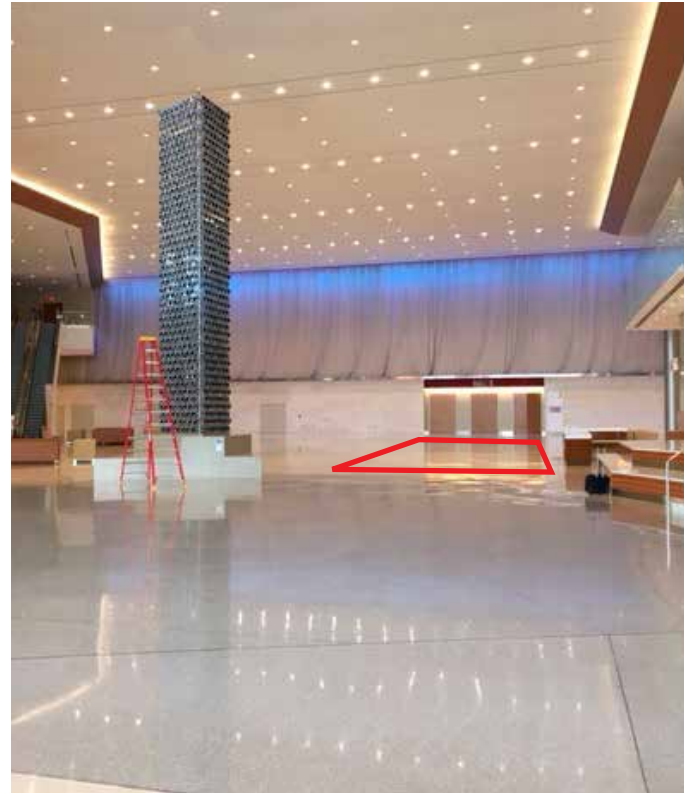

Dimensions: (W" x H")

Approximately 25' x 75' area

***Floor clings start on other side of tall sculpture and stop 40ft from entrance to Hall 3.*

Sponsorship: \$7,500

Production & Installation: \$10.25/ft²



Main Entrance Floor Clings

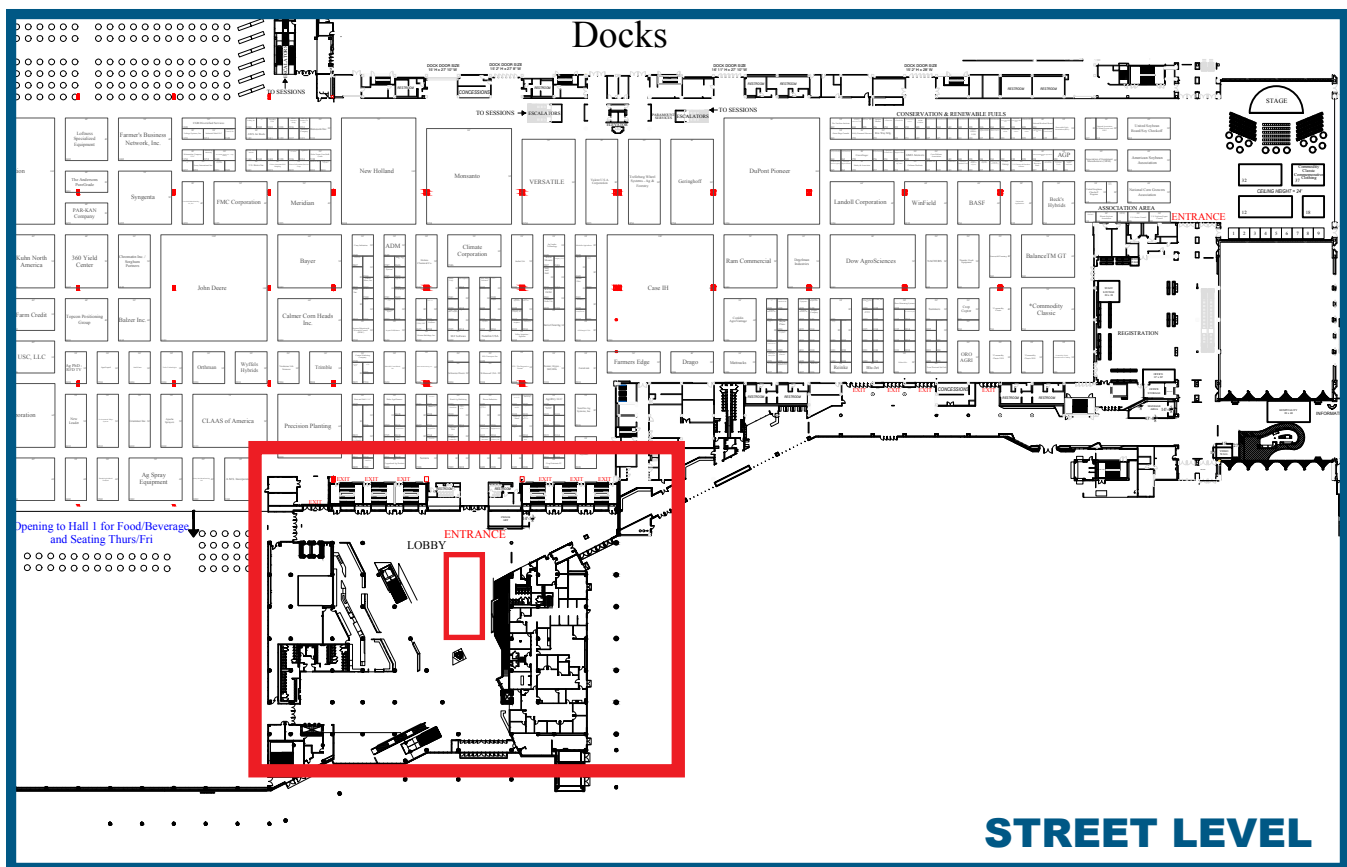
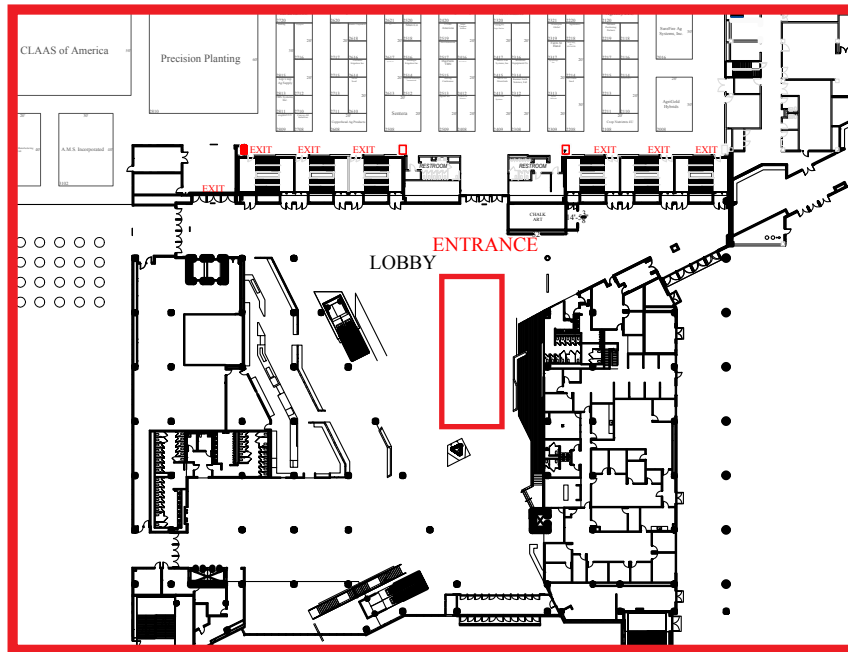

Registration Lobby Floor Cling

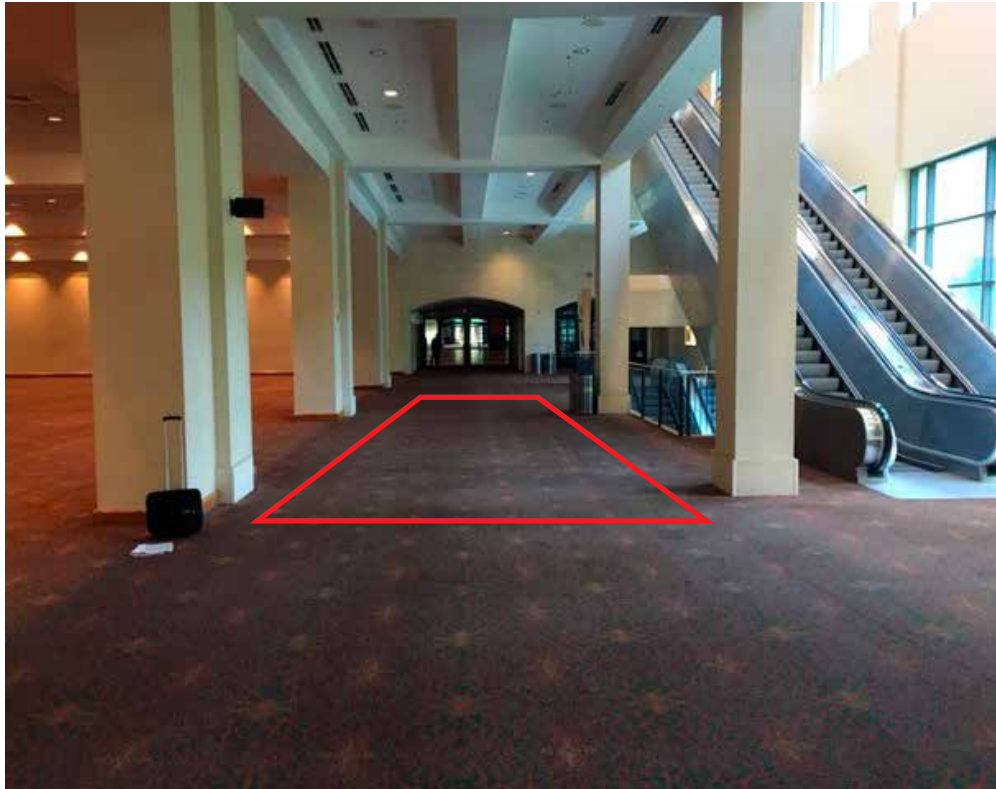

Dimensions: (W" x H")
Approximately 15' x 50' area

Floor clings start even with the escalator and stop 30ft from Show Entrance

Sponsorship: \$7,500

Production & Installation: \$10.25/ft²



Registration Lobby Floor Cling

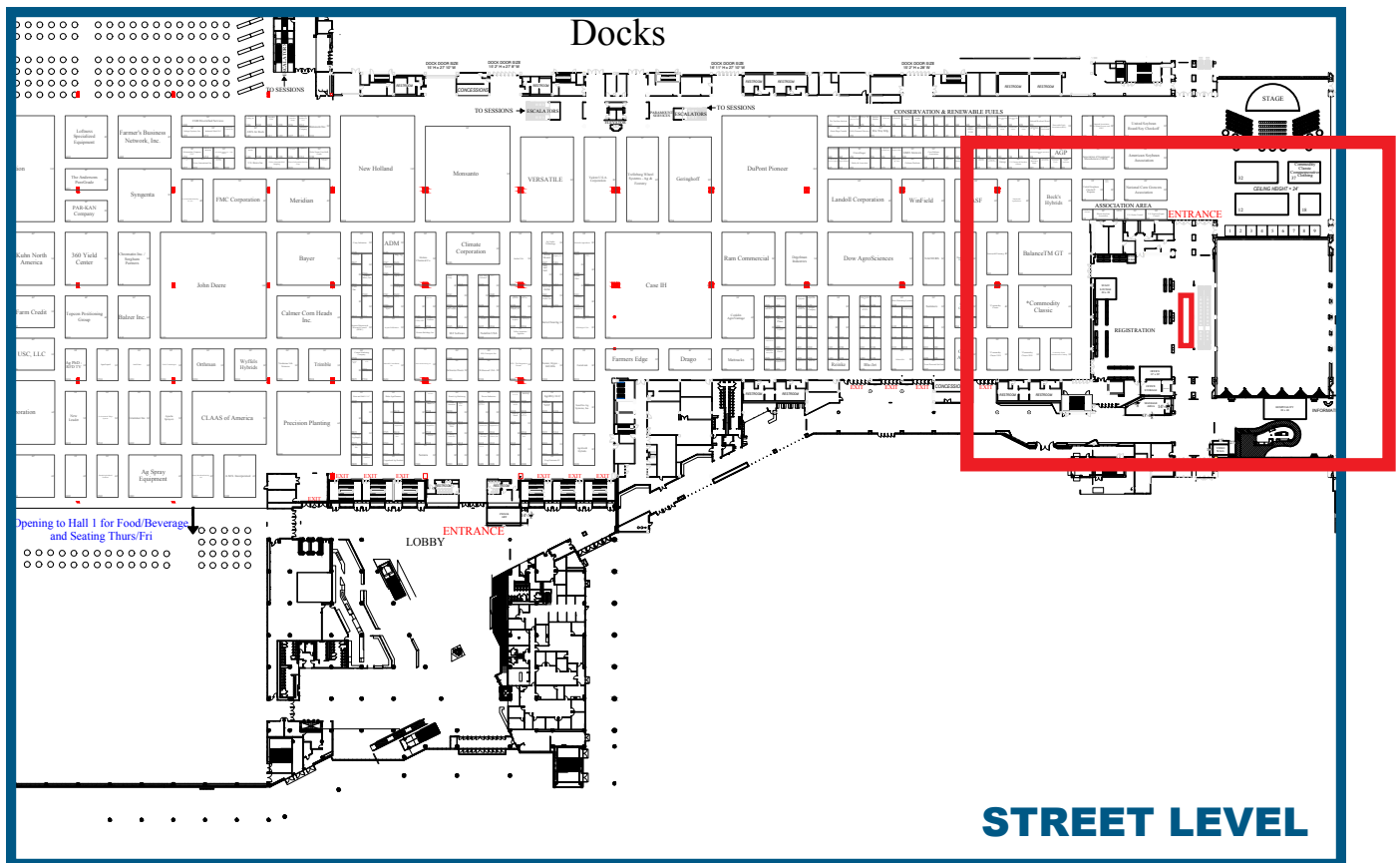
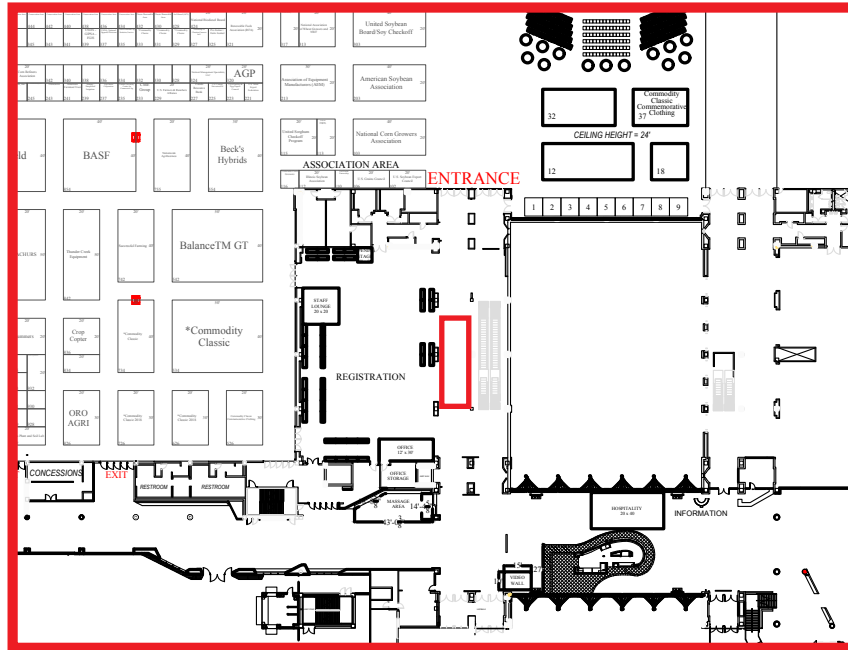

STREET LEVEL

Hall of Statues Floor Clings



Dimensions: (W" x H")

27' x 50'

*2 Sponsors- 1 on each side of statue in center.
Each location is approximately 27' x 50' with 15'
gap between the 2 sponsors.*

Sponsorship: \$5,000/ea **Production & Installation:** \$10.25/ft²



Hall of Statues Floor Clings

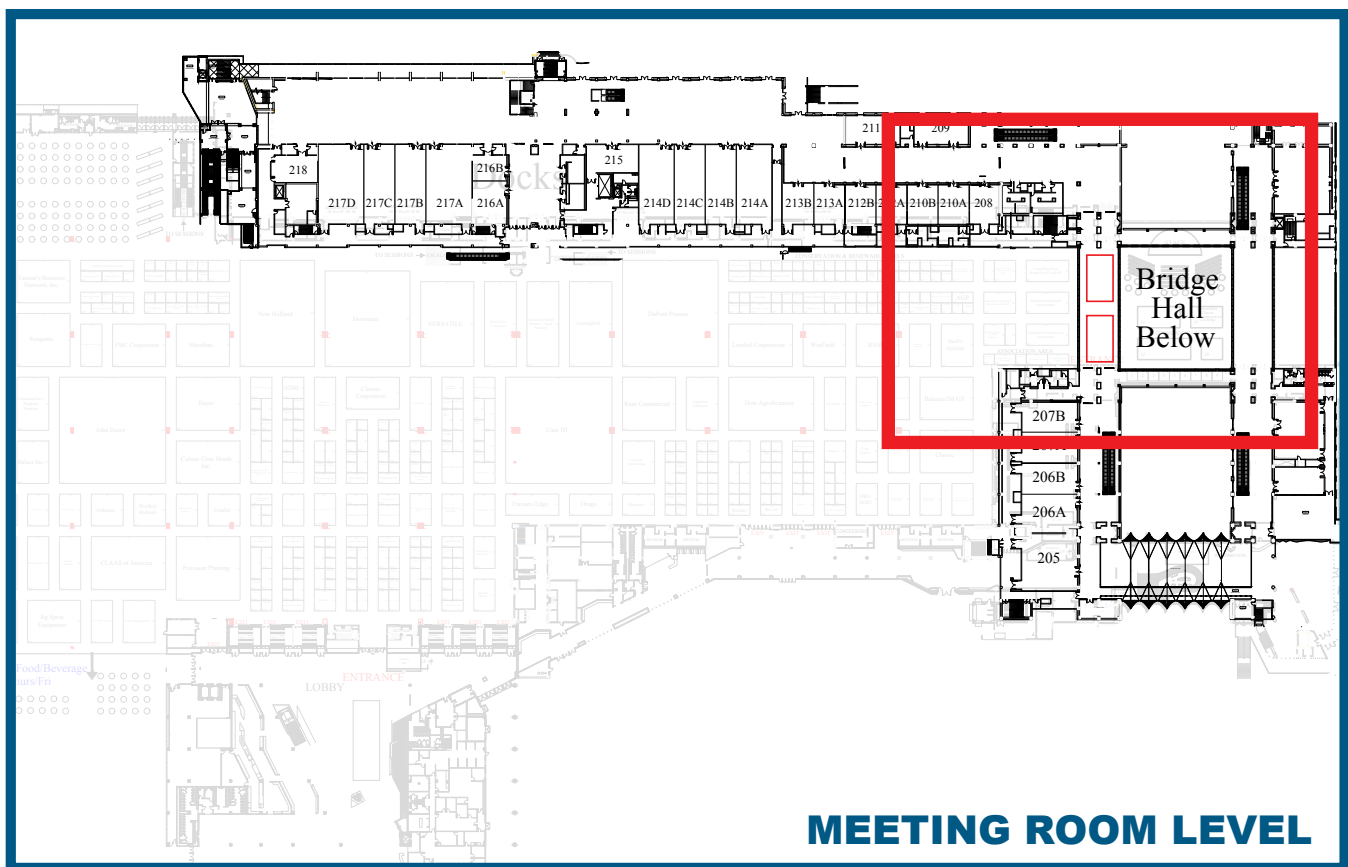
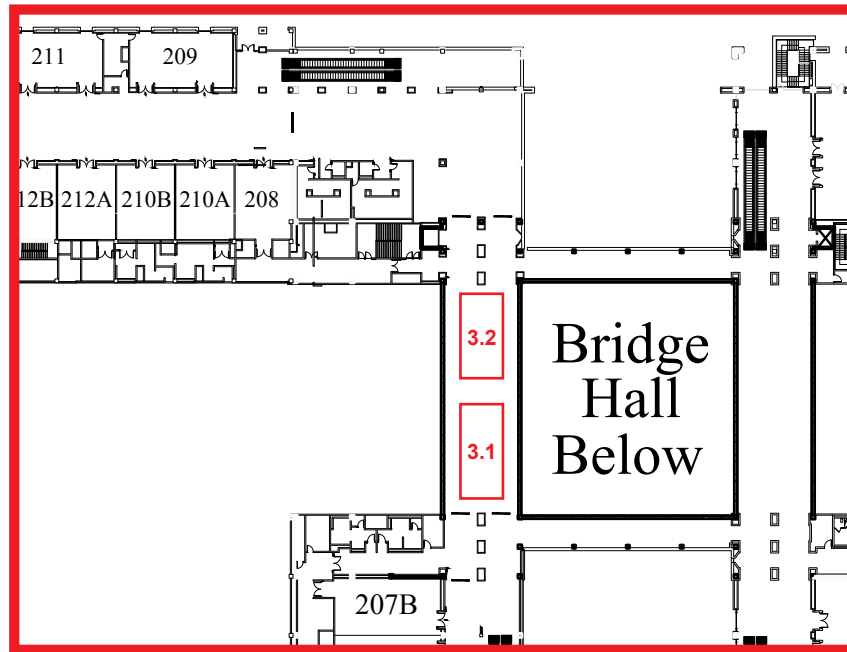

MEETING ROOM LEVEL

Room 208-213 Hallway Floor Clings

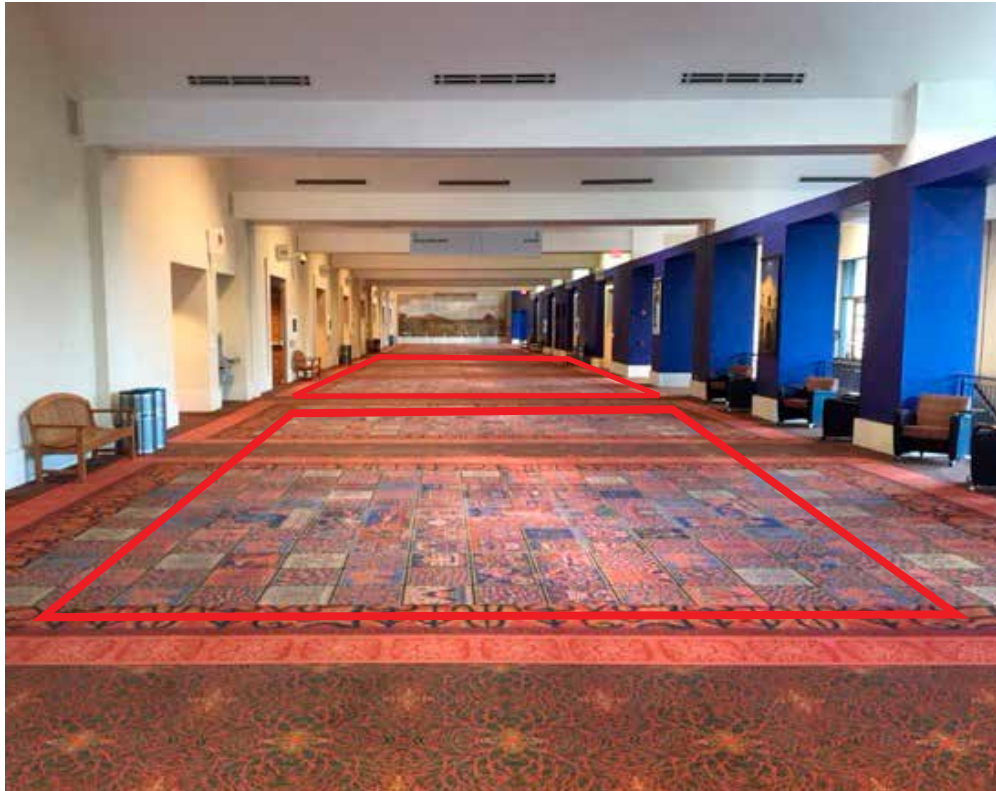

Dimensions: (W" x H")

34' x 120'

*2 Sponsors-Each sponsor has an approximate 34'x120' area.
There will be an approximately 20' gap between sponsors.*

Sponsorship: \$5,000/ea **Production & Installation:** \$10.25/ft²



Room 208-213 Hallway Floor Clings

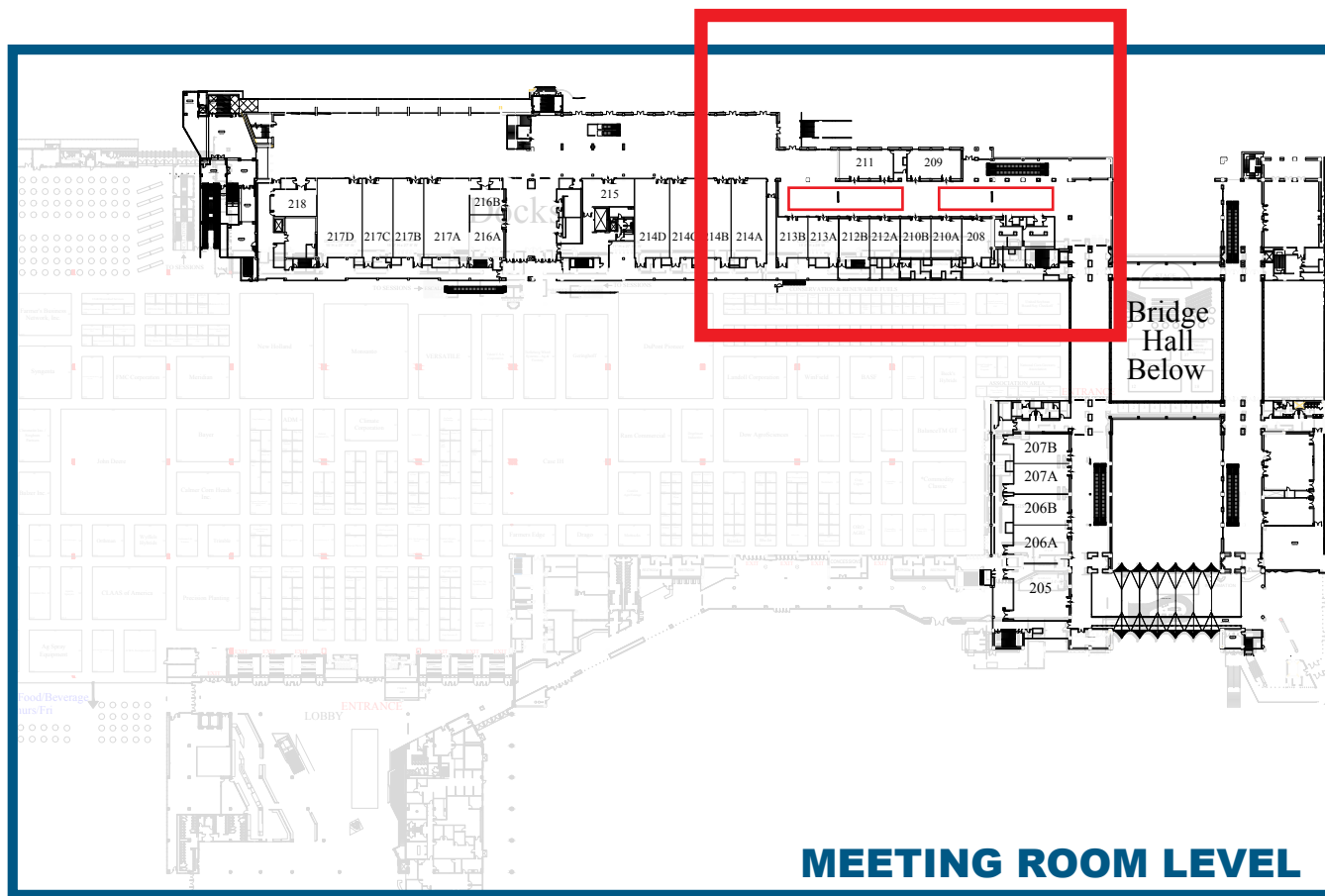
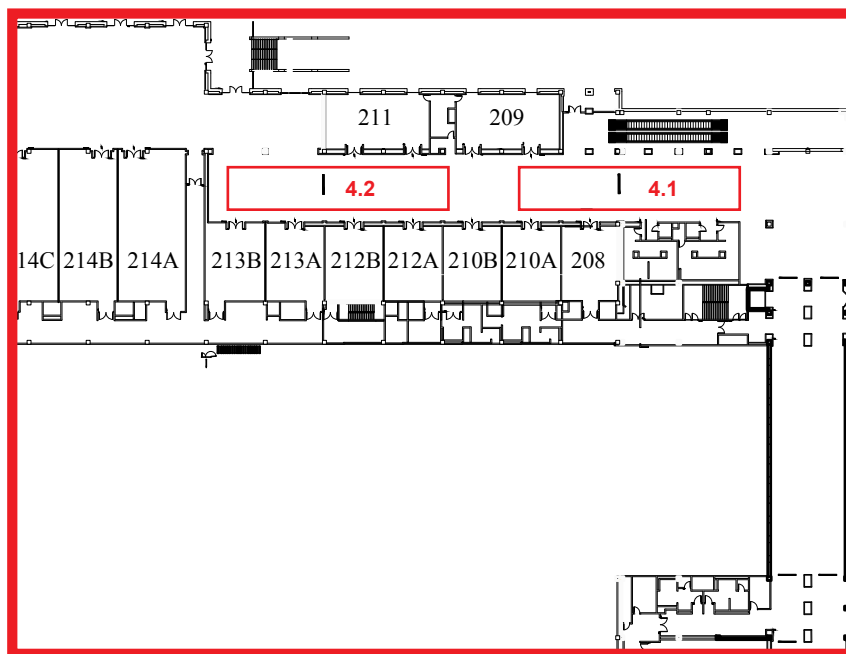

Connecting Walkway Floor Clings in Front of Hall 4B

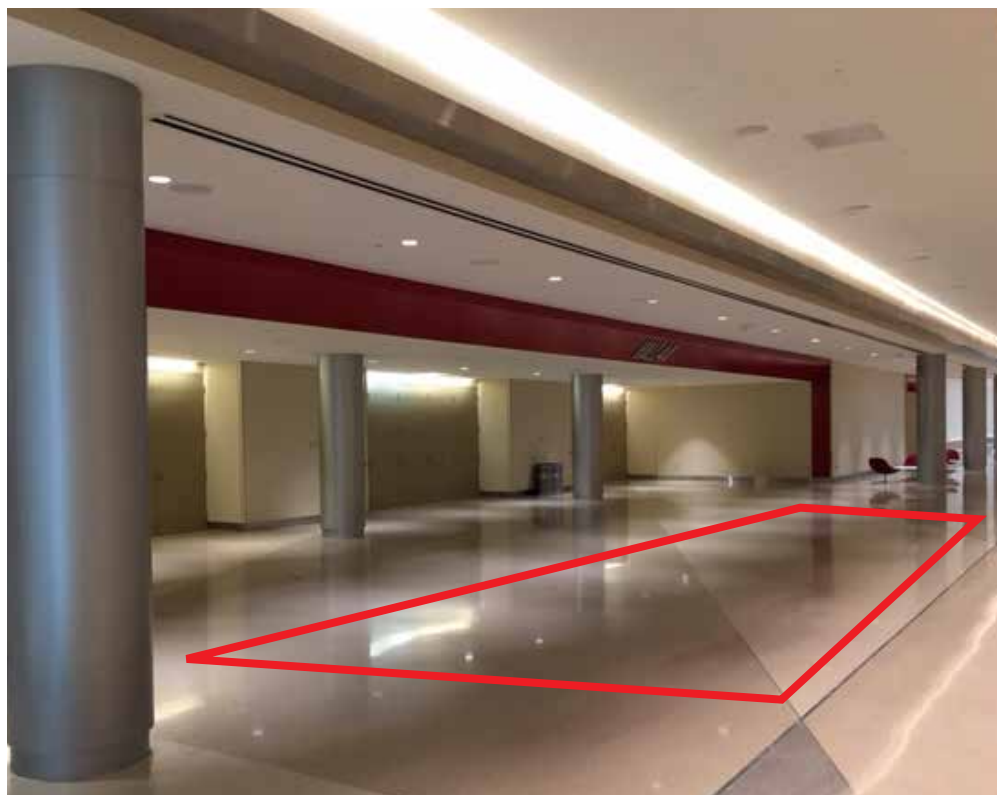

Dimensions: (W" x H")
20' x 70'

Must be at least 10' off each column.

Sponsorship: \$7,500

Production & Installation: \$10.25/ft²



Connecting Walkway Floor Clings in Front of Hall 4B

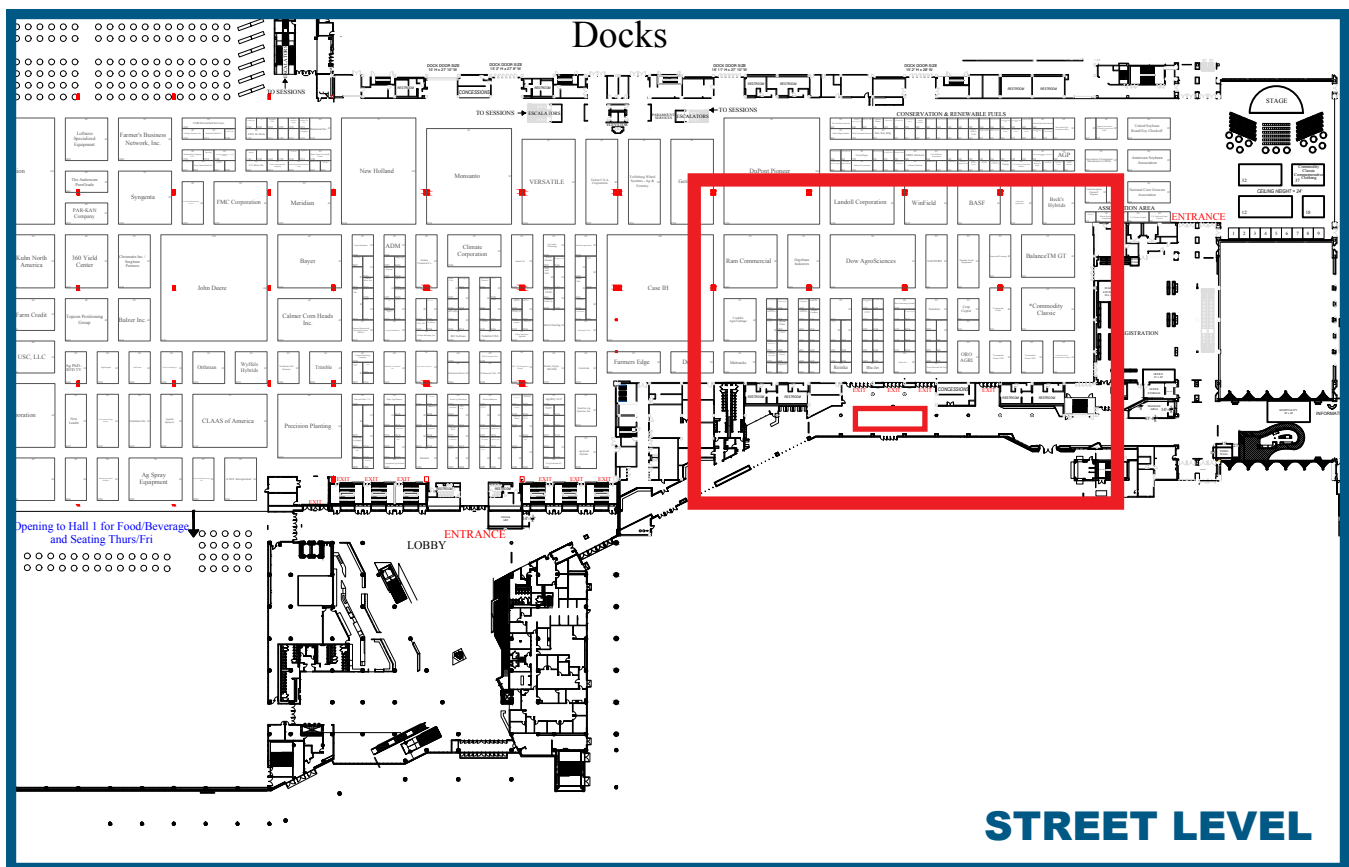
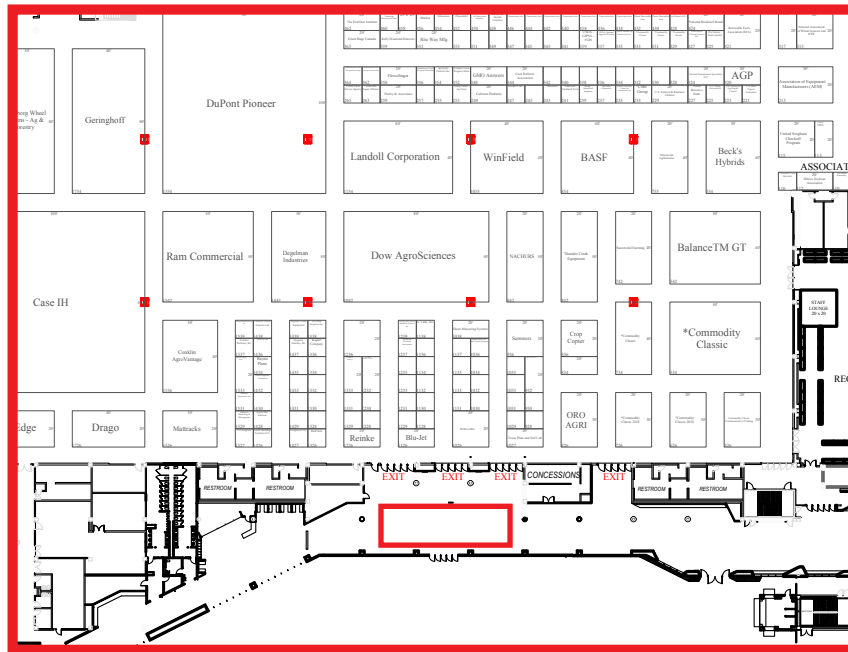

STREET LEVEL

Connecting Walkway Floor Clings in Front of Seating and Concession Area

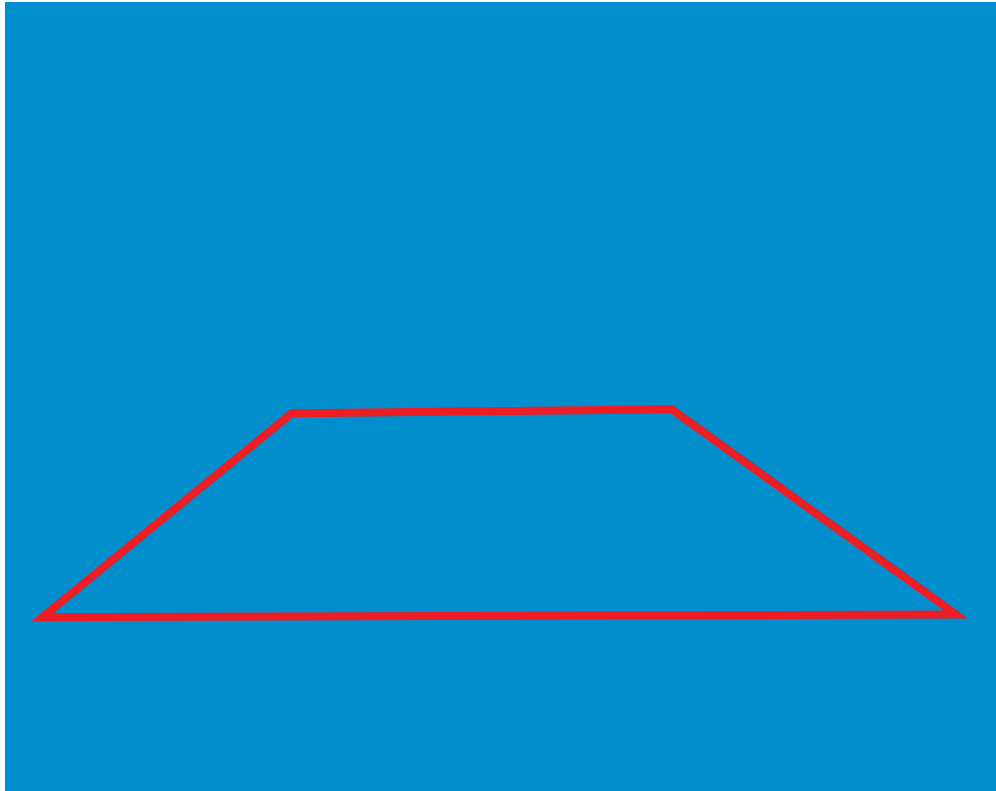

Dimensions: (W" x H")
15' x 100'

Sponsorship: \$7,500

Production & Installation: \$10.25/ft²



Connecting Walkway Floor Clings in Front of Seating and Concession Area

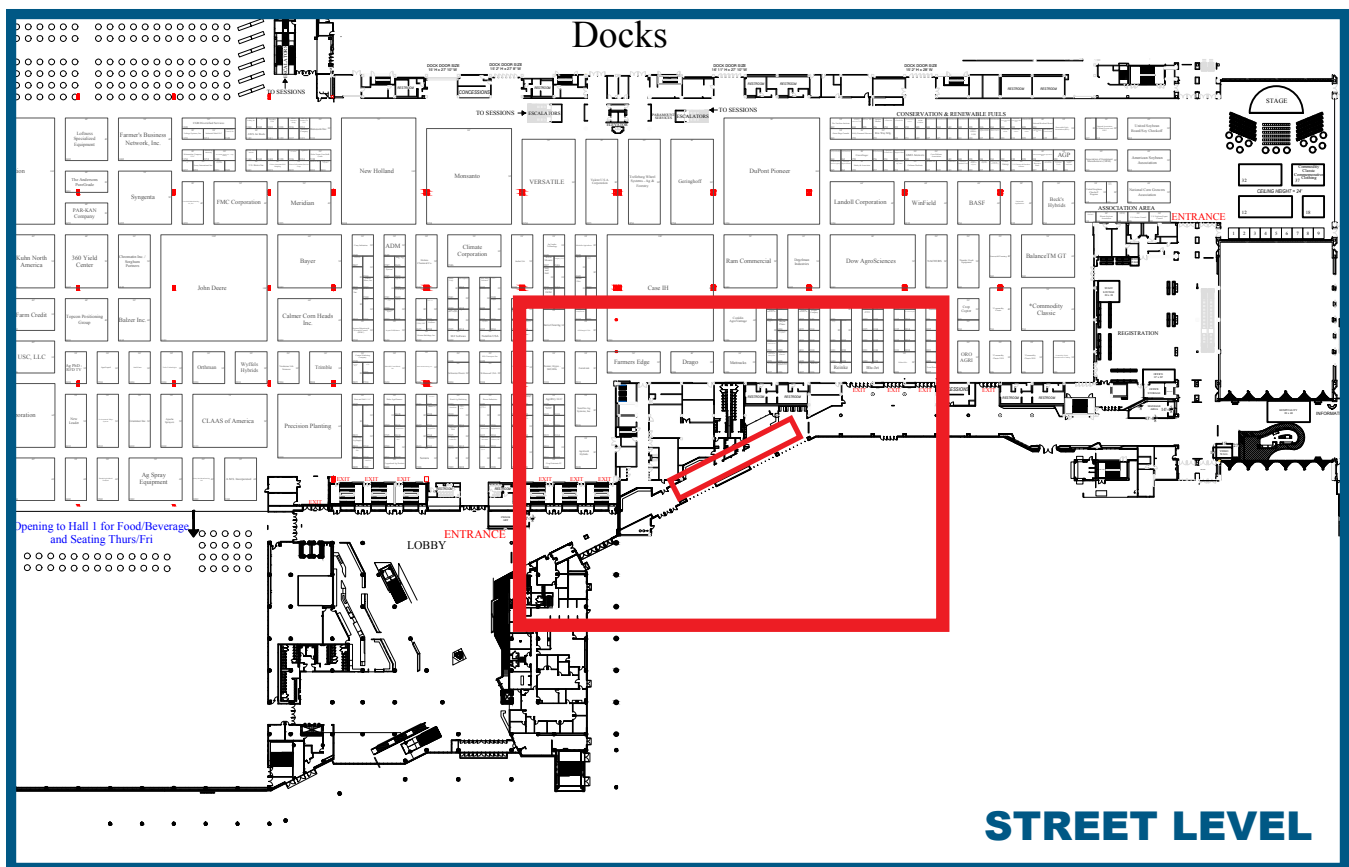

Park View Charging Station Sign & Floor Clings



Dimensions: (W" x H")

121" x 23.5" (x1)

Floor Clings: 24" x 24" (x2)

Floor clings can also be placed directly in front of charging station

*Sign above charging station is available as well.
Please contact Abby Podkul for information*

Additional charging station locations may be included

Sponsorship: \$15,000

Production & Installation: \$10.25/ft²



Park View Charging Station Sign & Floor Clings

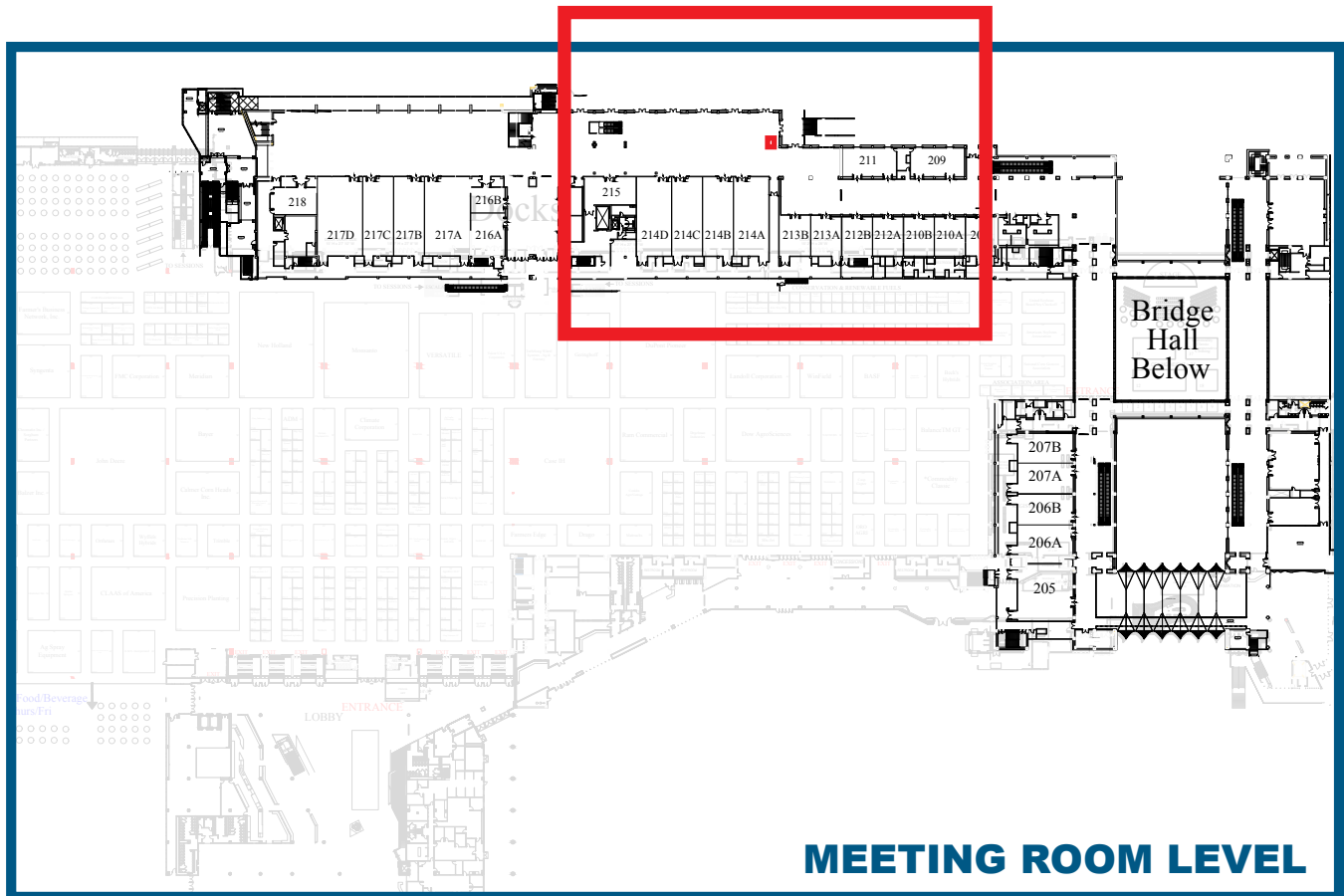
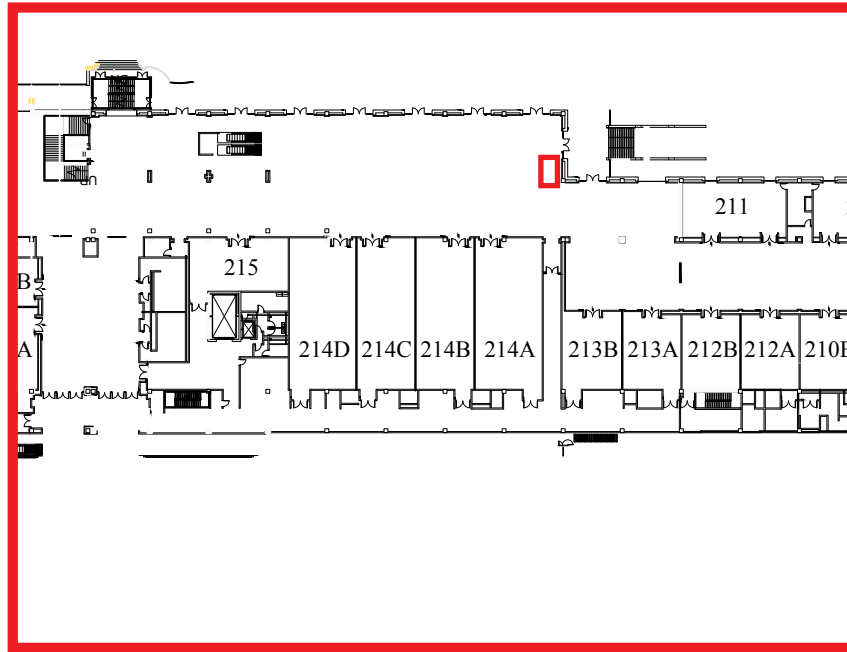

Main Lobby Escalator & Wall Below Glass

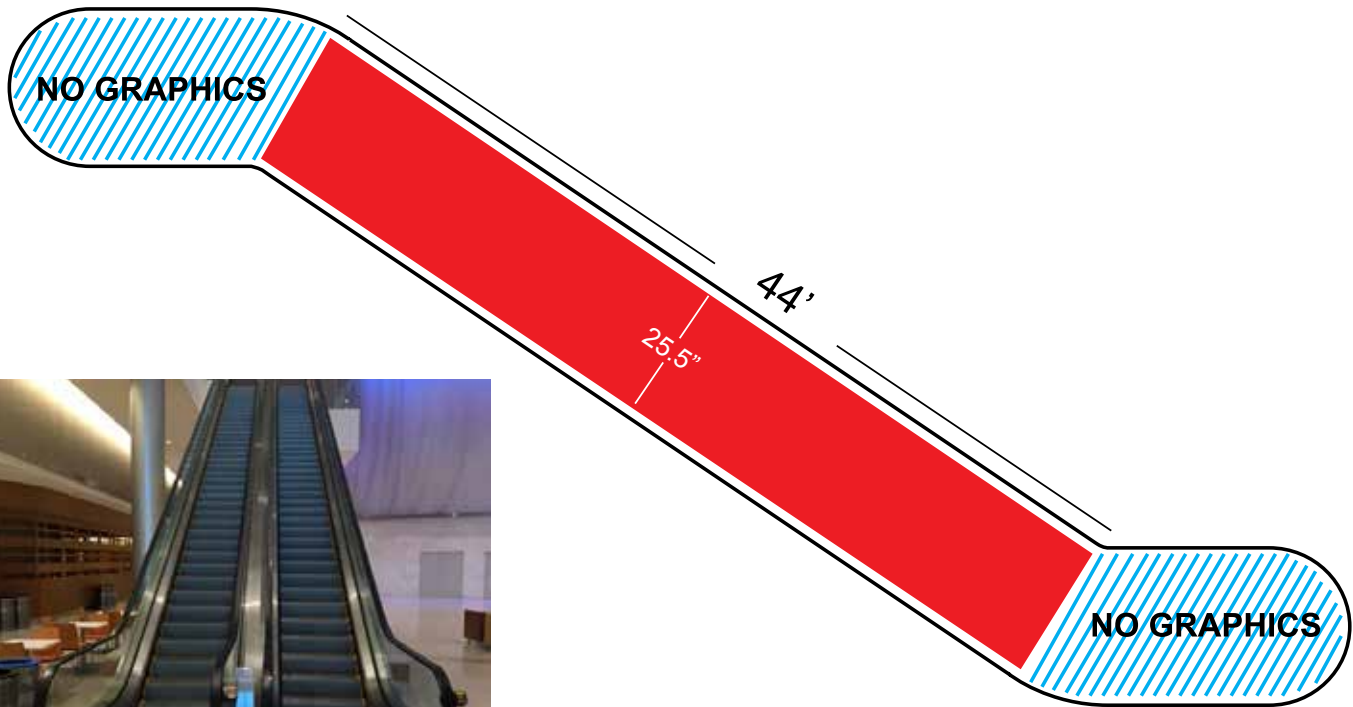

Dimensions: (W" x H")

Glass Sides: 44' x 25.5" (x4)

Flat Metal Divider: 12.5" x 57'2" (x1)

Outside Glass: TBD (x1)

Outside White Wall: TBD (x1)

1.1 = Escalator glass sides facing in
& flat divider

1.2 = Escalator glass side facing out
& wall below

Sponsorship: 1.1 - \$7,000
1.2 - \$7,500

Production & Installation: \$10.25/ft²



Main Lobby Escalator & Wall Below Glass

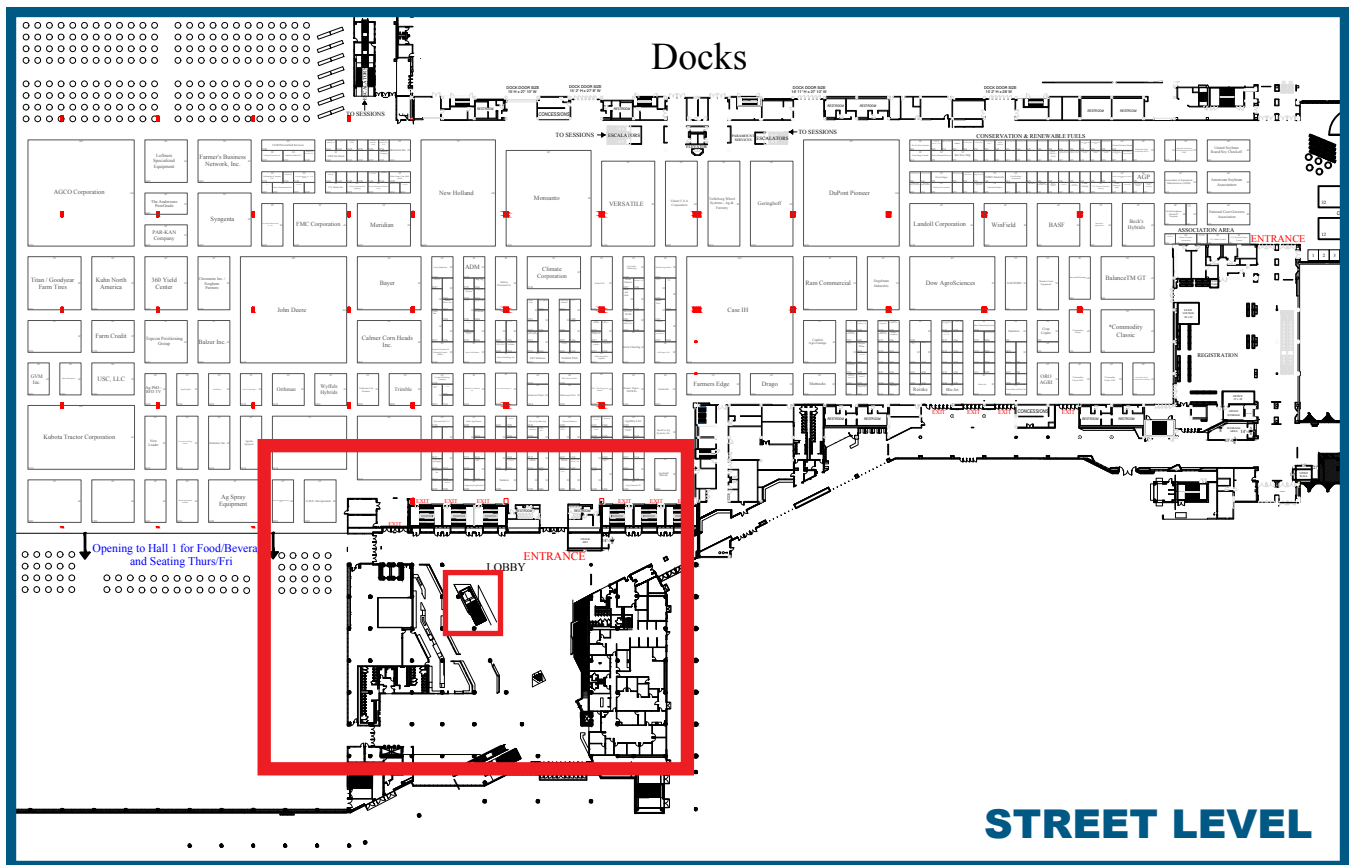

STREET LEVEL

Registration Escalator Up to Hall of Statues

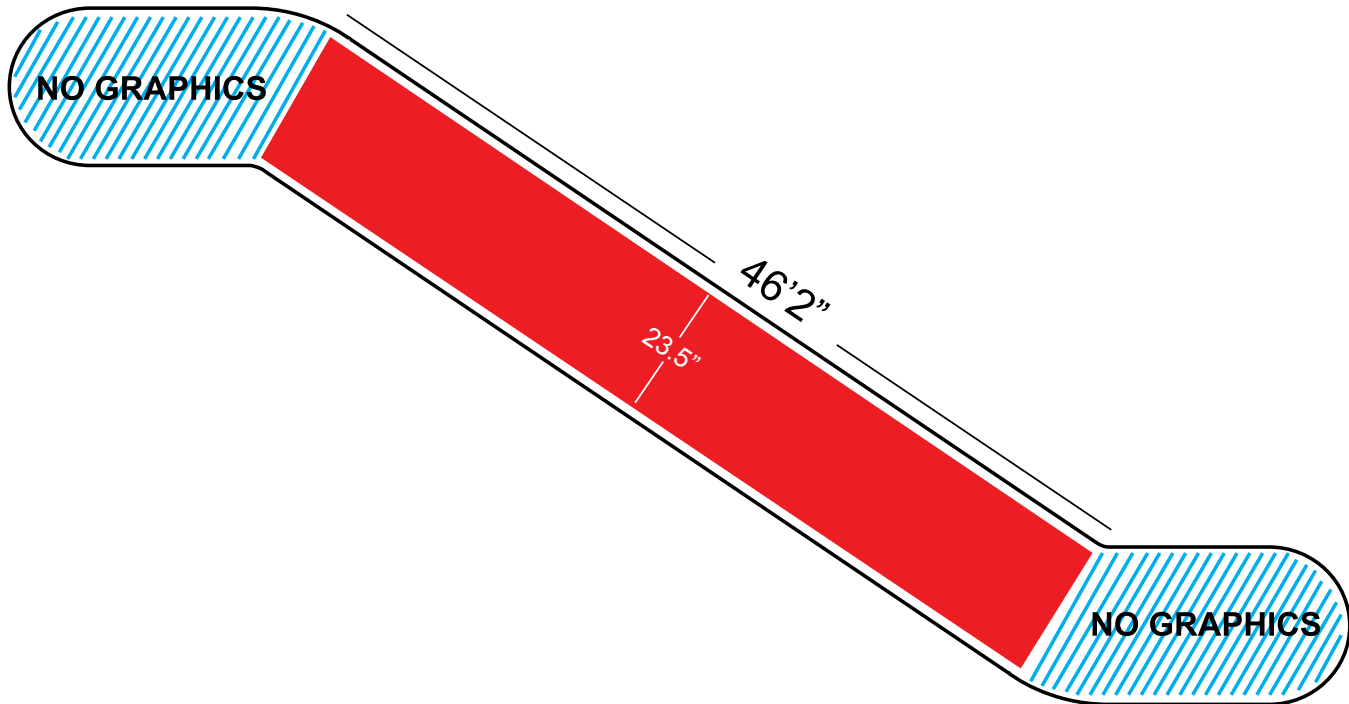

Dimensions: (W" x H")

Metal Sides: 46'2" x 23.5" (x4)

Flat Metal Divider: 11.5" x 62' (x1)

Sponsorship: \$10,000

Production & Installation: \$10.25/ft²



Registration Escalator Up to Hall of Statues

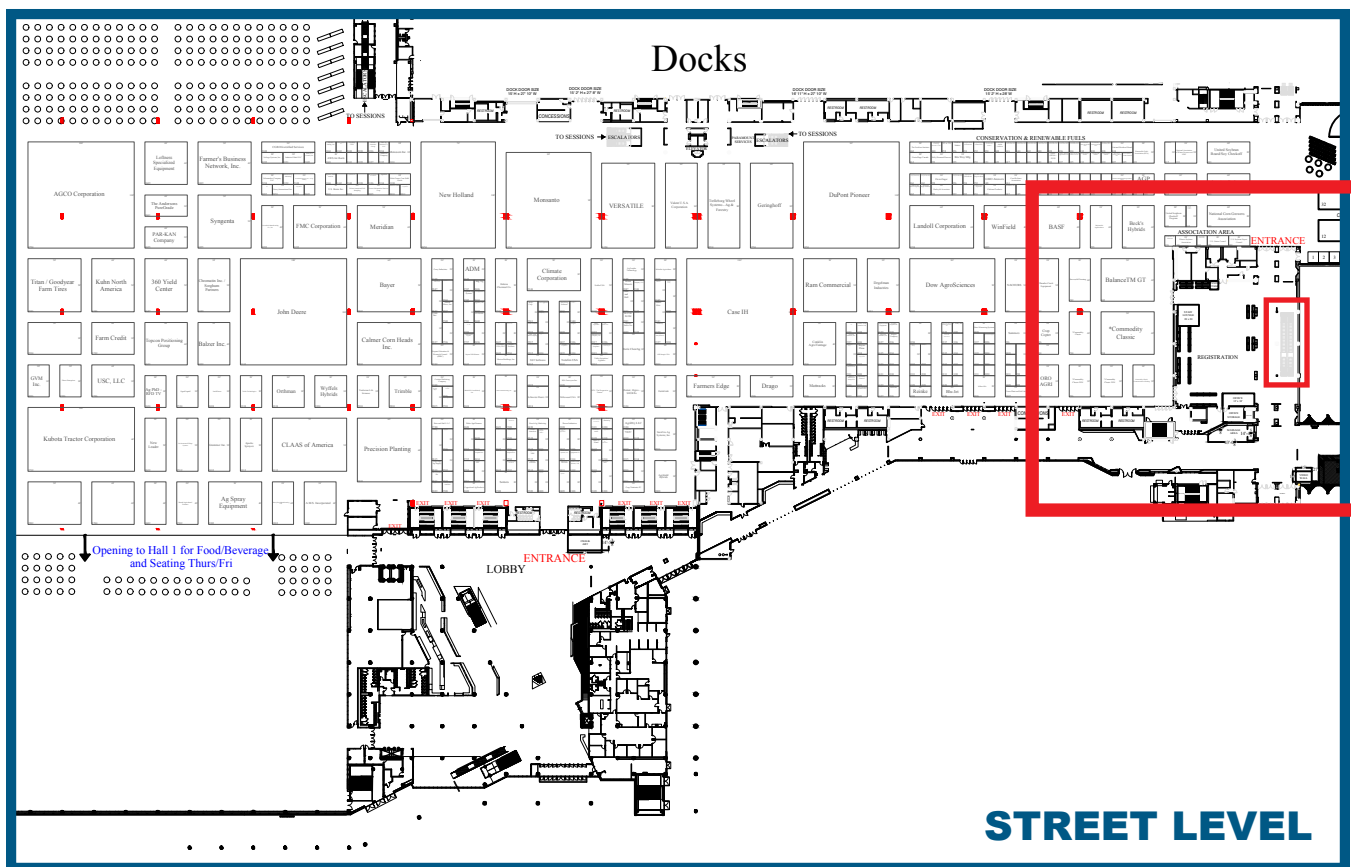
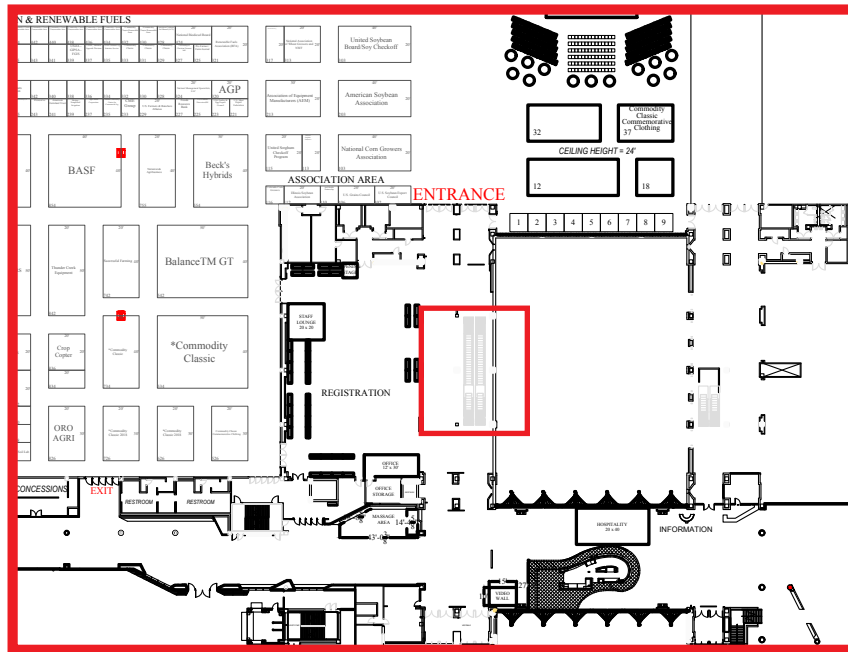

STREET LEVEL

Escalator Inside Hall 3 Exhibit Hall

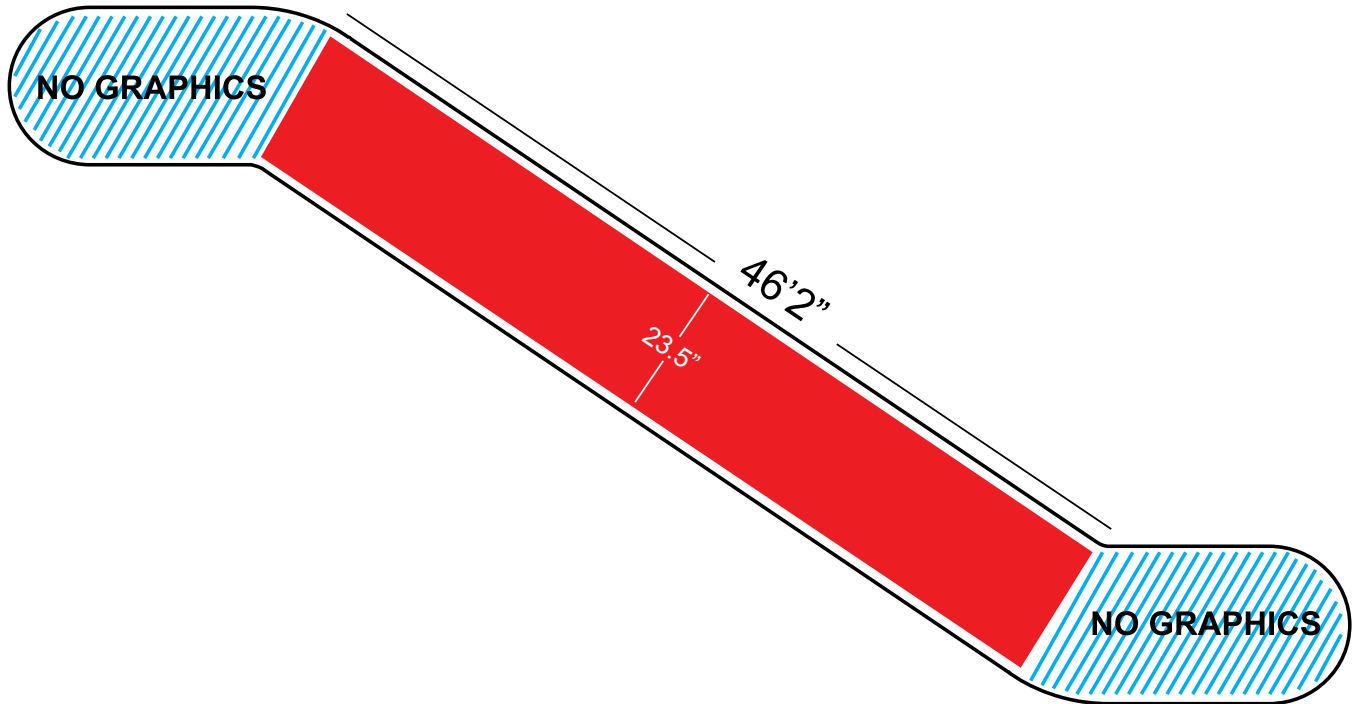

Dimensions: (W" x H")

Metal Sides: 46'2" x 23.5" (x4)

Flat Metal Divider: 12" x 62'3" (x1)

*This escalator goes from inside Hall 3
up to the meeting rooms*

Sponsorship: \$7,000

Production & Installation: \$10.25/ft²



Escalator Inside Hall 3 Exhibit Hall

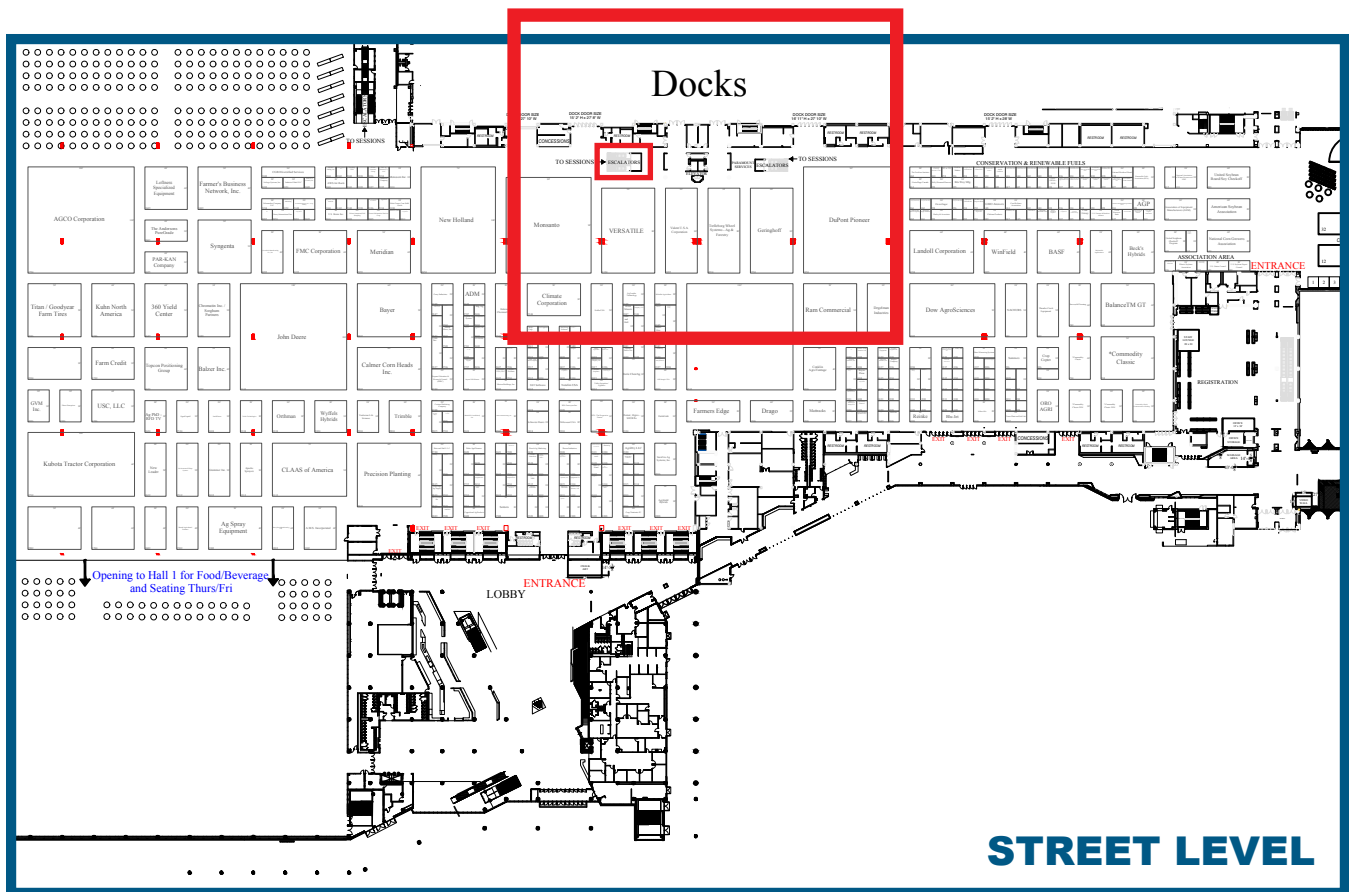
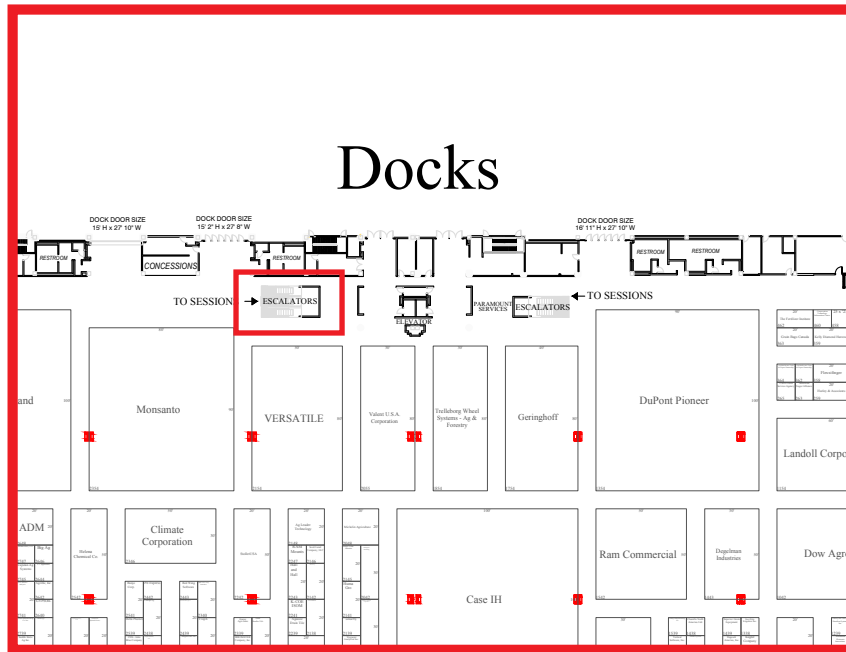

Escalator Inside Hall 4 Exhibit Hall

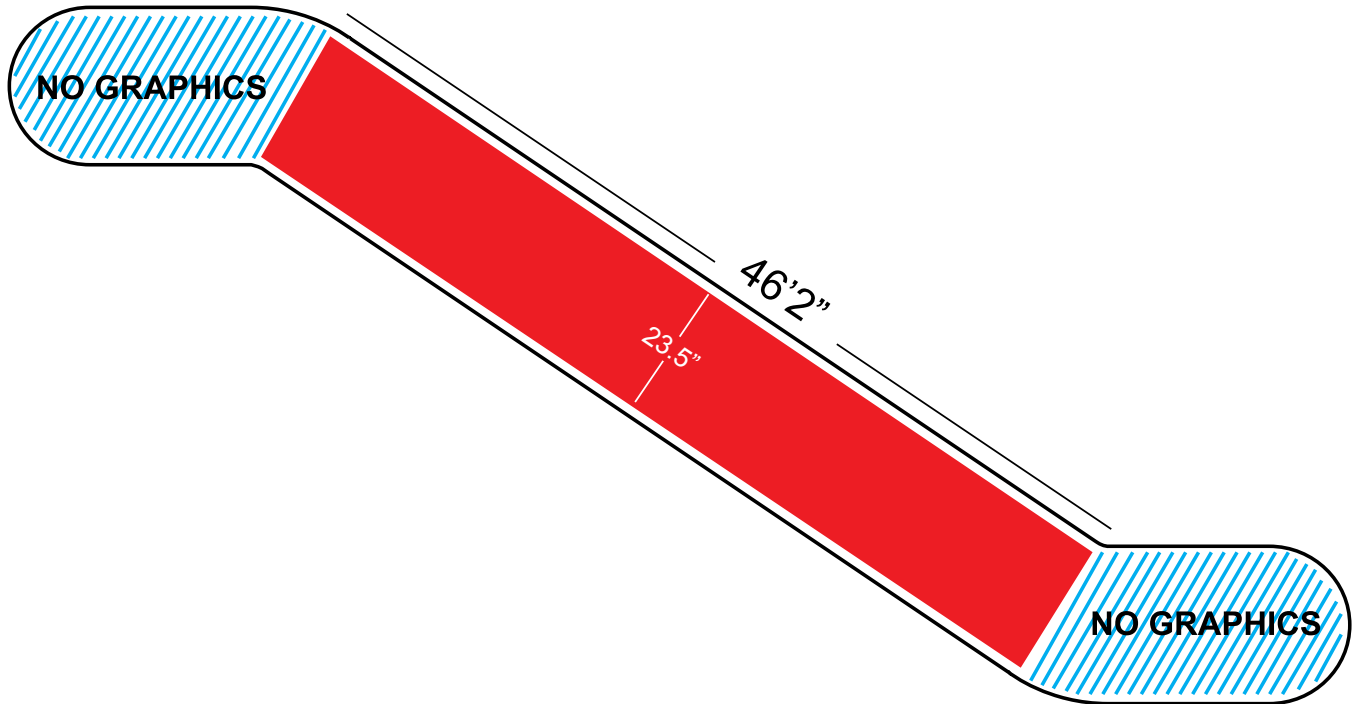

Dimensions: (W" x H")

Metal Sides: 46'2" x 23.5" (x4)

Flat Metal Divider: 12" x 62'3" (x1)

*This escalator goes from inside Hall 4
up to the meeting rooms*

Sponsorship: \$7,000

Production & Installation: \$10.25/ft²



Escalator Inside Hall 4 Exhibit Hall

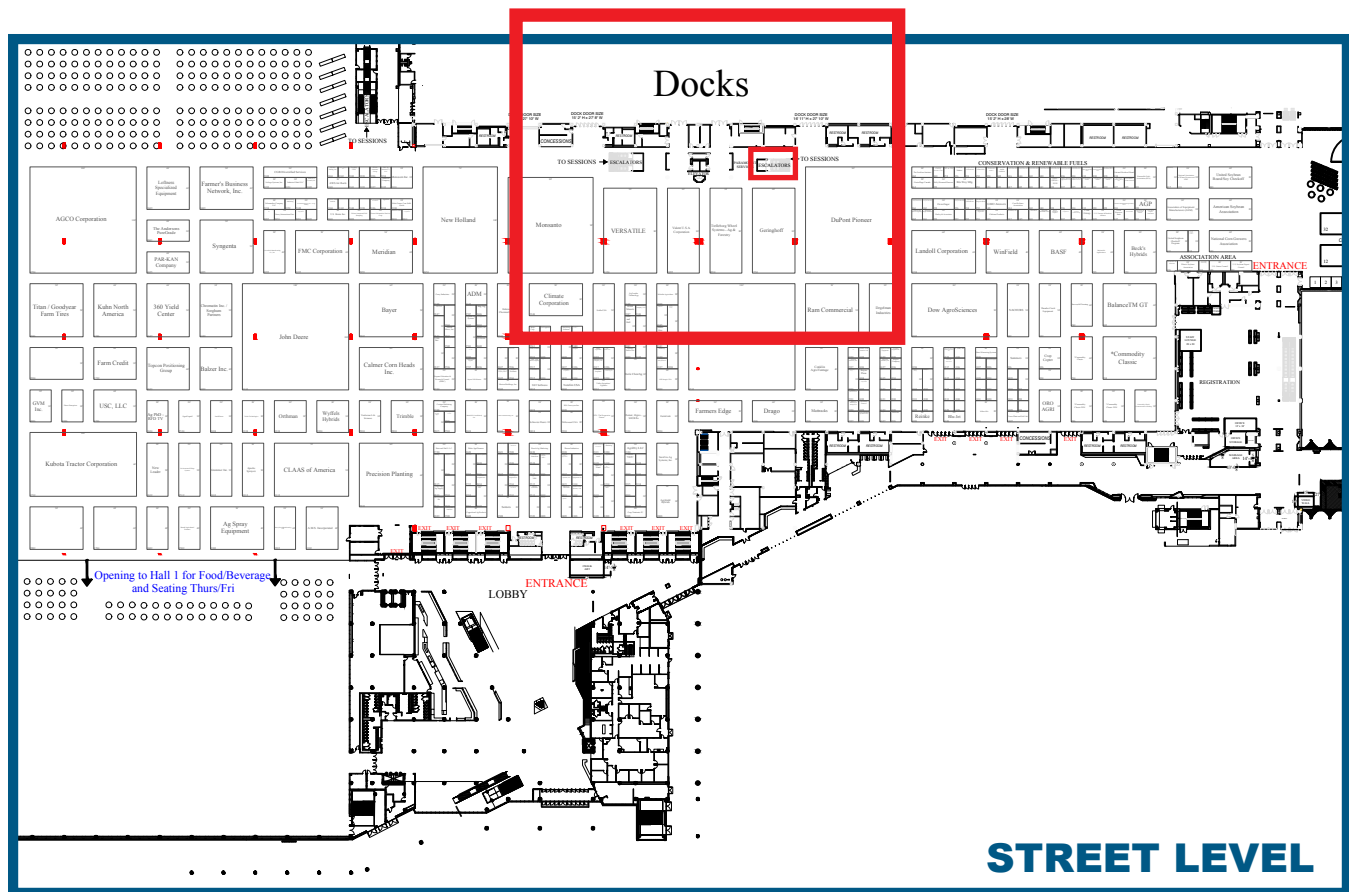
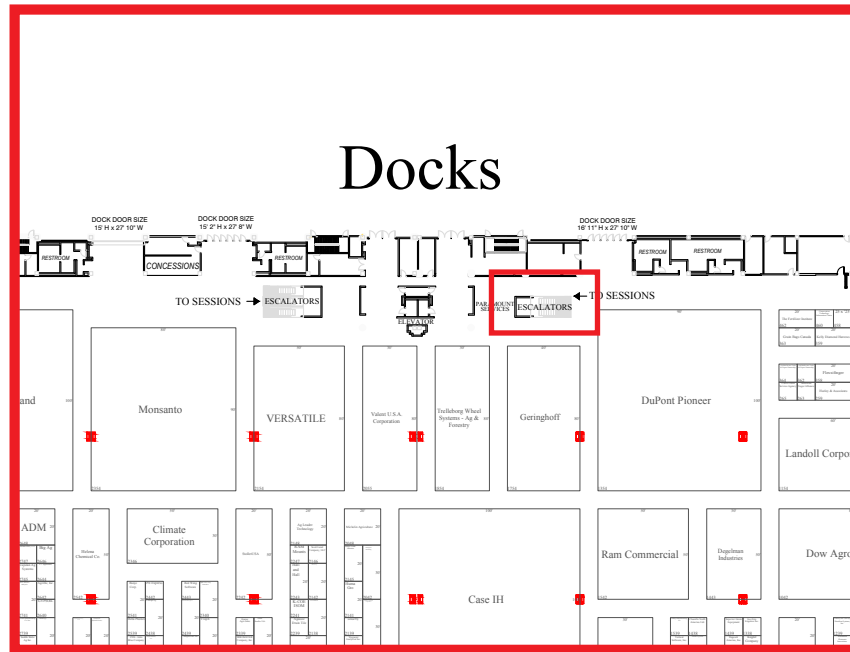

Room 208-213 Hallway Banners 1.1, 1.2 & 1.3

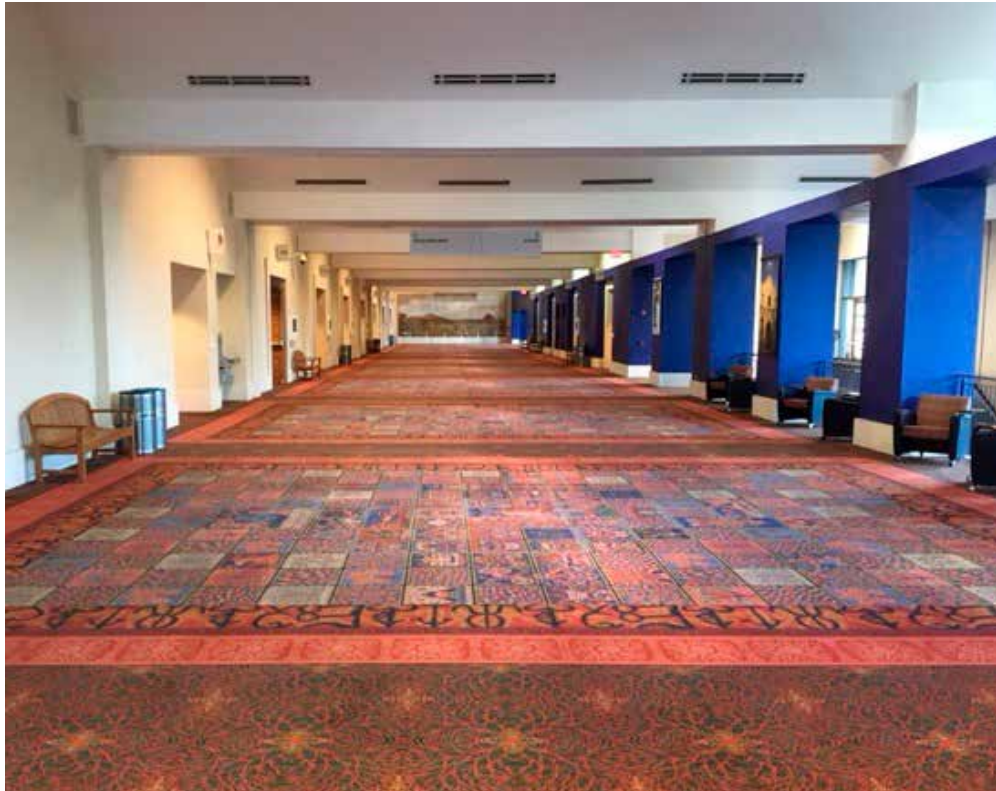

Dimensions: (W" x H")

31' x 3' (x3)

Double Sided at every other ceiling point.

1.1-Split between men & women's restroom.

1.2-Split between 210 A&B room.

1.3-Split between 212 A&B room.

Sponsorship: \$4,000/ea

Production & Installation: \$9.75/ft²

Room 208-213 Hallway Banners 1.1, 1.2 & 1.3

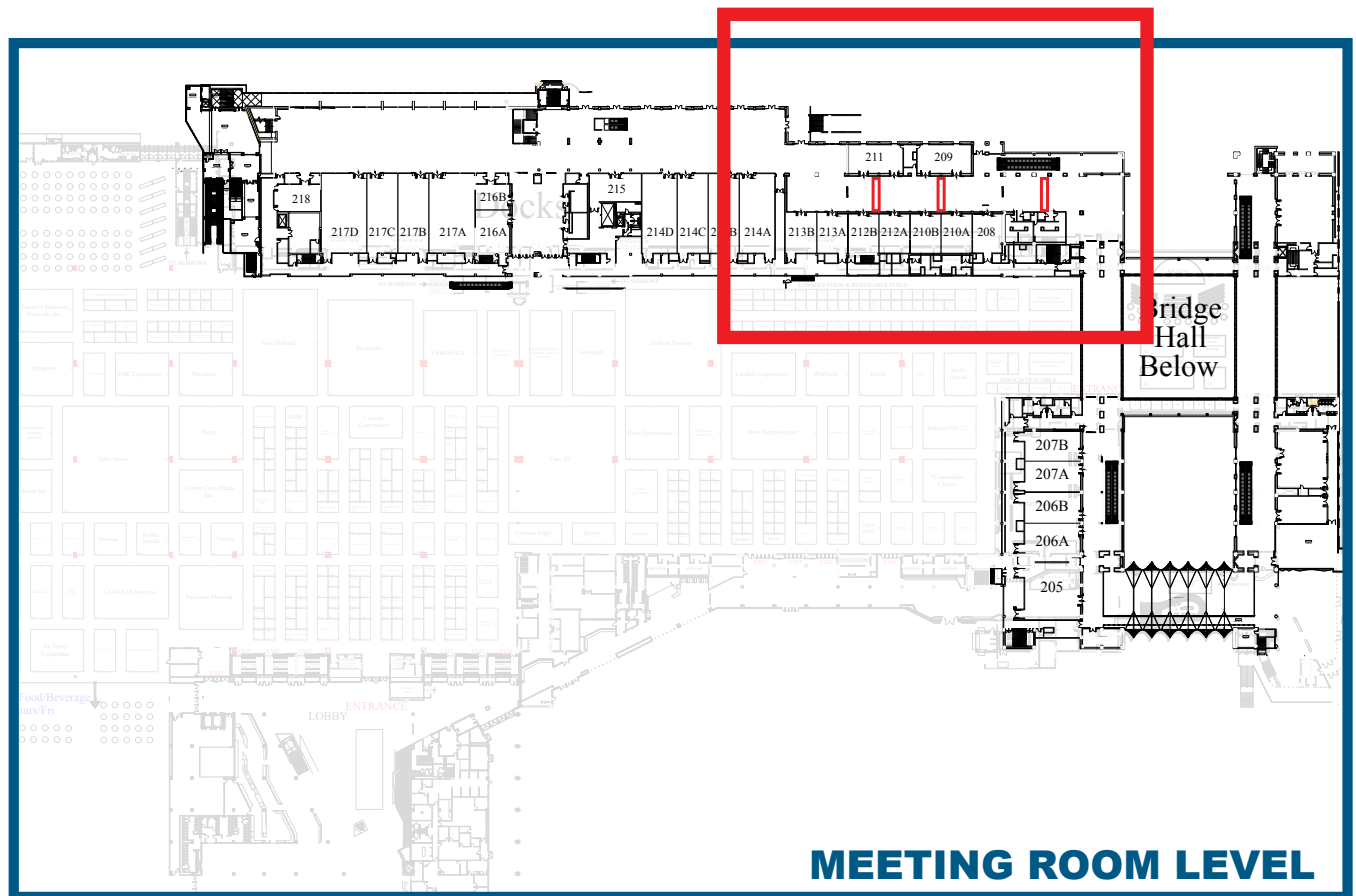
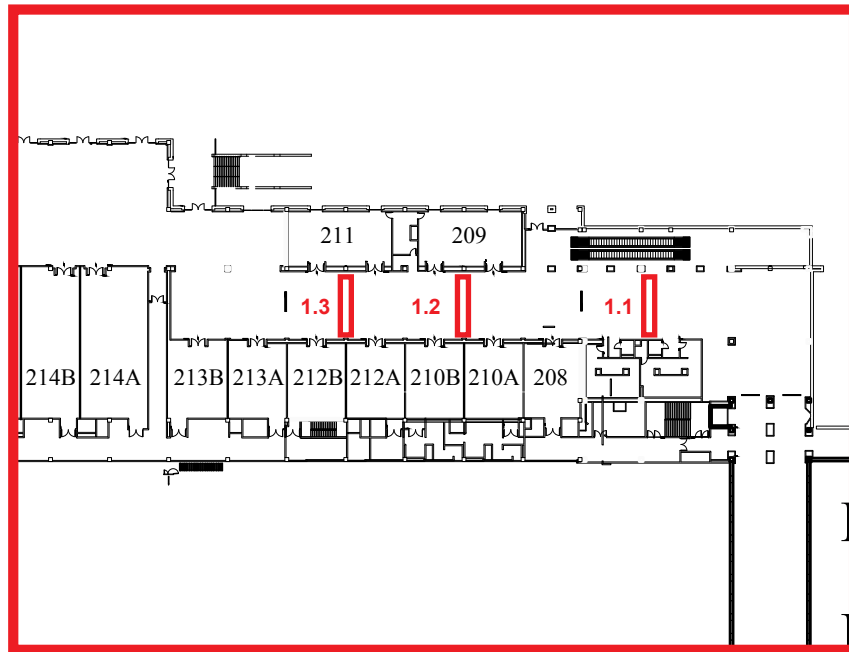

Park View Hanging Banners



Dimensions: (W" x H")

20' x 3' (x2)

Double sided off ceiling points.

2.1 next to 214B

2.2 next to 214D

Sponsorship: \$4,000/ea

Production & Installation: \$9.75/ft²

Park View Hanging Banners

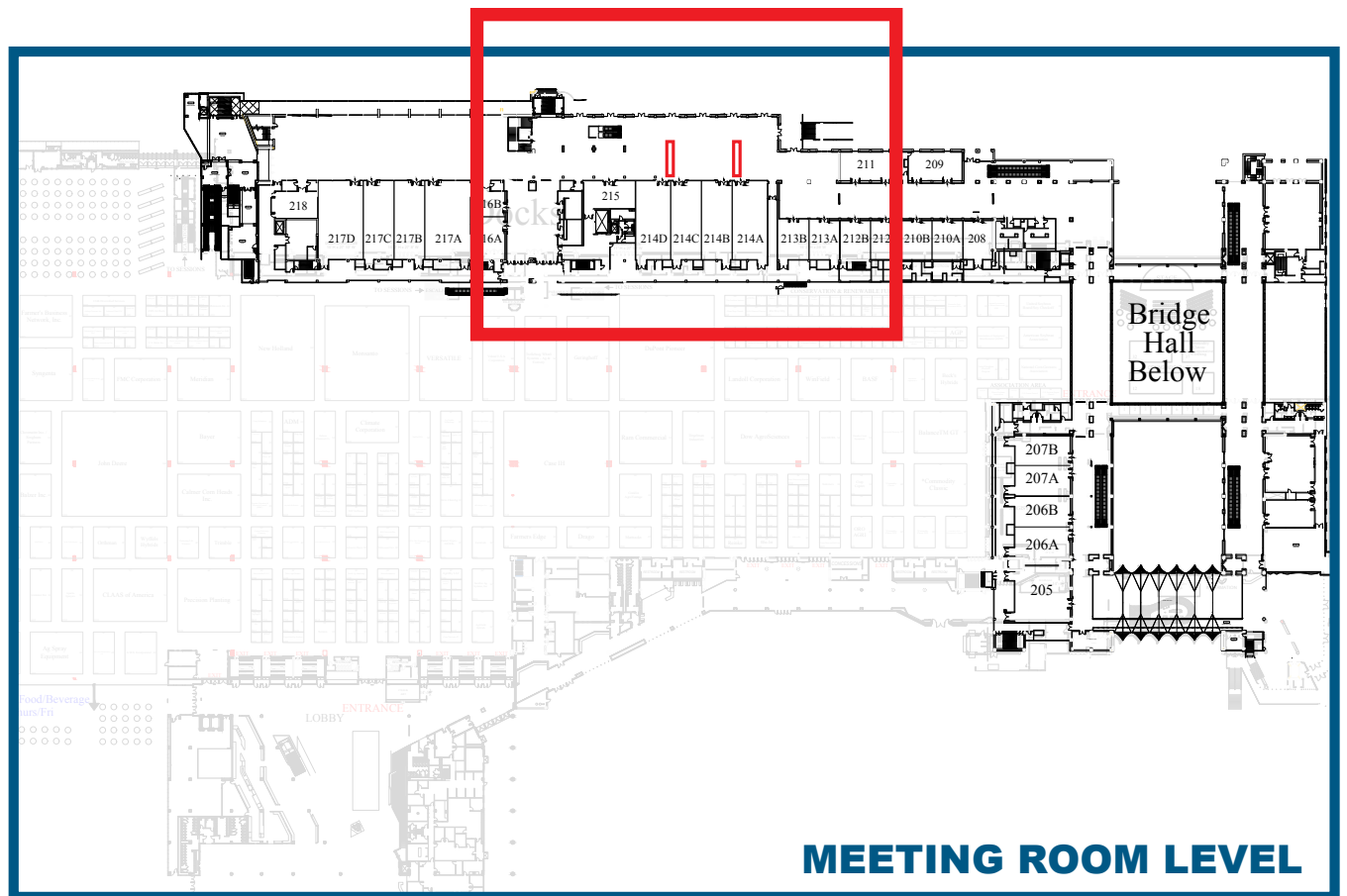
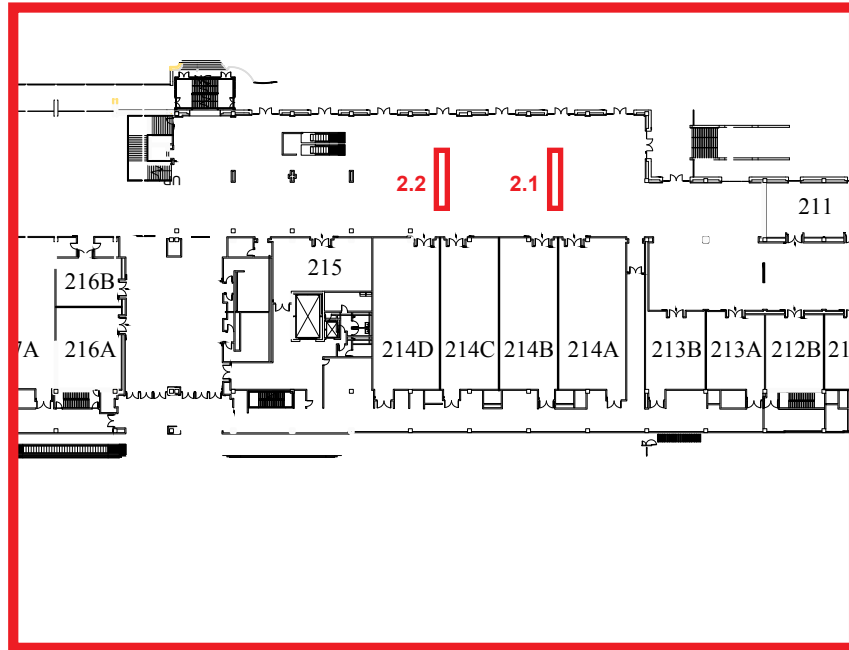

Outside Space to Right of Main Entrance

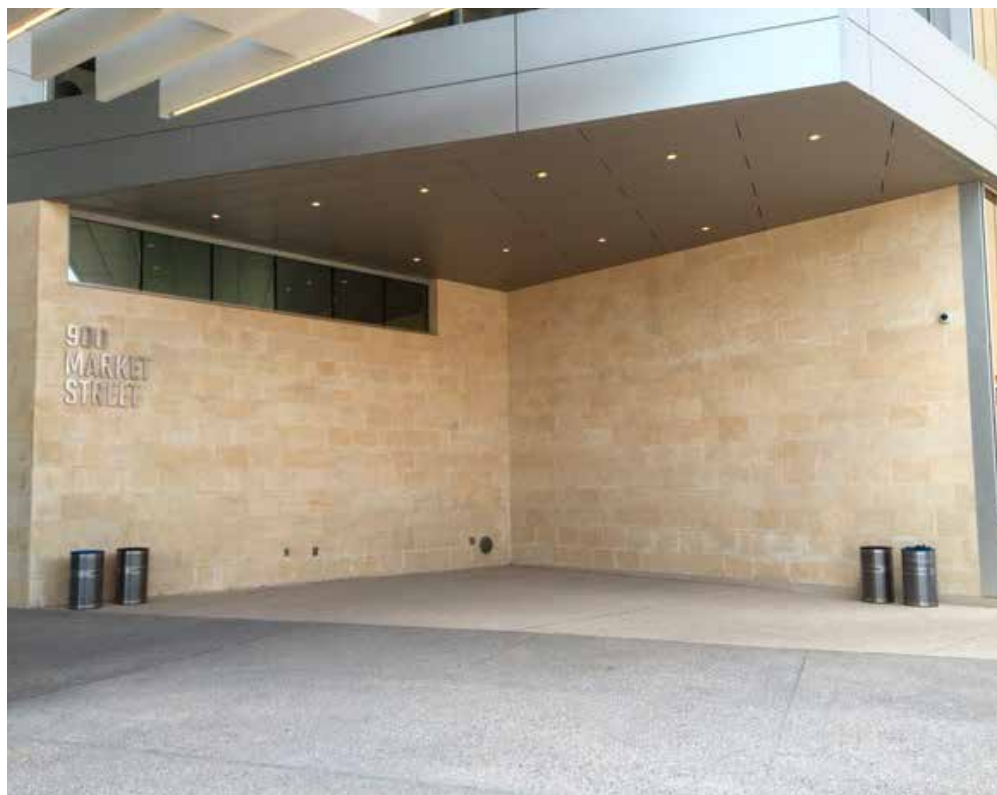

Dimensions: (W" x D" x H")

W: 30' D: 30' H: 20'

Sponsorship: Call for Pricing

Production & Installation: \$10.25/ft²



Outside Space to Right of Main Entrance

